

## CS SlimSlider®

Cavity sliders are all about space. The term 'cavity slider' refers to the cavity pocket (incl. track + carriages) installed within wall framing that allows a door to <slide> inside the wall. The benefit is a solution that leaves clear space on both sides of the wall and opening, encouraging cohesion between spaces.

**CS SlimSlider®** is designed to fit into 70mm framing. That's why it is 'slimmer' than our other cavity sliders. It makes the CS SlimSlider ideal for renovations where the existing wall framing is of an earlier vintage, e.g. 3" wall framing that has shrunk over time to 70mm.

CS SlimSlider  
is a residential  
cavity slider  
designed  
to fit into  
70mm framing.

This unit is also commonly specified in houses built with framing finished at 70mm x 45mm.

The split jambs are made from extruded aluminium for strength and are etch-primed, ready for a paint quality finish.



↑ 1 - CS SlimSlider Single unit fitted with a flush door.

## Design Features & Options

**It's all about space.  
But slimmer.**

- ▮ Available in standard sizes or **can be made to specification** up to 2100mm high & 910mm wide.
- ▮ Designed to fit into standard wall framing (70mm x 35mm kiln dry).
- ▮ Due to wall framing thickness constraints, the timber split jambs have been replaced with etch-primed aluminium jambs for rigidity.
- ▮ Jambs are ready for painting - suitable for 10mm wall linings only.
- ▮ Available as Single or Bi-Parting (double) units, with or without door/s fitted.
- ▮ Can be specified with almost any choice of door, including our aluminium **CS NewYorker**.
- ▮ Door carrying capacity: 90kg, using 2-wheel carriages.
- ▮ All aluminium components screwed together for strength and reliability.
- ▮ Supplied fully-assembled, ready for installation.



▲ 3 - CS SlimSlider Single and Bi-Parting units fitted with CS NewYorker doors.



▲ 2 - CS SlimSlider Single unit fitted with a 'v' grooved door.

4 - CS SlimSlider Bi-Parting unit fitted with one-light joinery door. ▶

# Why specify CS CavitySliders?



**Standard 2-wheel carriage, mounting plate and track\***

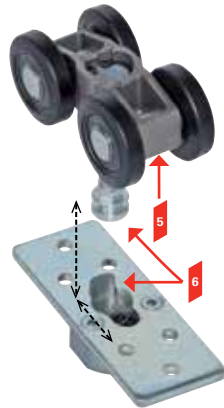

**Standard 4-wheel carriage & mounting plate\***

\*NZ Patent 533838.  
Aust patent 2005 202818 (2011)

## Service

The only New Zealand manufacturer of cavity sliders to have NZ covered with 4 branches. All branches offer a free site measure & quote.

## We're Local

CS FOR DOORS is 100% New Zealand owned and our products are 100% New Zealand Made.



↑ Come see our door systems at CS FOR DOORS' NZIA Award winning Head Office & Showroom

## Quality

Our aim is to make the best quality cavity sliders. Therefore every component is uniquely designed with this in mind.

## Technology & Innovation

Our engineers focus on constantly developing new products & refining existing ones. That's why our products come with a number of unique features. A few exclusive **CS CavitySliders** features (refer to pics on left):

- 1 Heavy duty one-piece extruded aluminium track.
- 2 Minimal clearance means carriages/wheels cannot jam or jump off the track.
- 3 Large diameter wheels with precision ground bearings for smooth running.
- 4 Radiused track reduces friction and allows dust to be pushed into the gutters so the door always slides smoothly.
- 5 4-wheel carriages are standard on all doors over 90kg. Body made from cast stainless steel for strength & reliability.
- 6 **CarriSnap™** quick release system allows easy removal of the door from the cavity pocket.

## Product Range

We have over 50 standard products. If you require a custom solution, we can make to order.

## Quality Assured

CS CavitySliders are BRANZ appraised.



## Our Guarantee

**WE GUARANTEE PRODUCT WITH OUR SERIAL CODES FOR UP TO TEN YEARS\***

\*Guarantee conditions apply. Contact CS FOR DOORS for details.

Check out the full range of products and use our online calculator at:

[www.csfordoors.co.nz](http://www.csfordoors.co.nz)

## Technical Information

### How to specify (example)

Product:	~ CS SlimSlider by CS FOR DOORS
Location:	~ Ensuite bathroom
Door leaf dimensions:	~ 1980mm x 760mm
Door type:	~ Hollow core with steel inserts
Door finish:	~ V-Groove
Single or Bi-Parting:	~ Single
Jamb type & finish:	~ Grooved (for wall linings); paint quality
Framing material & size:	~ 70mm timber framing
Wall lining thickness:	~ 10mm only
Door gear type & finish:	~ CS 90kg track system
Handle type:	~ CaviLock CL200 A1010 See CaviLock on our website for more options

Full specifications are available on [www.masterspec.co.nz](http://www.masterspec.co.nz)

### Plan view (CAD)

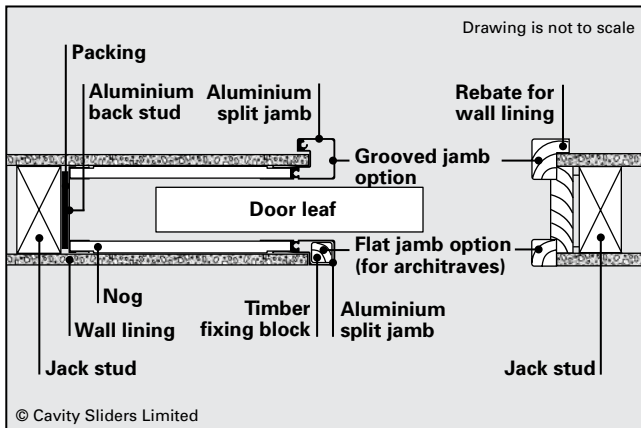

© Cavity Sliders Limited

### Elevation (CAD)

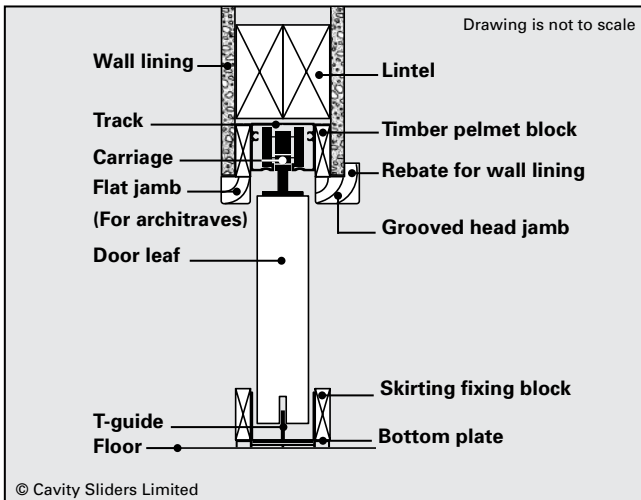

© Cavity Sliders Limited

### Useful formulas (online calculator @ [www.csfordoors.co.nz](http://www.csfordoors.co.nz))

Dimension Required	Single	Bi-Parting
Trim height*	DH + 95	DH + 95
Trim width*	(DWx2) + 30	(DWx4) + 10
Distance between jambs*	DW - 31	(DWx2) - 42
Distance over jambs (Arch)	DW + 13	(DWx2) + 6
Distance over jambs (Grvd)	DW + 31	(DWx2) + 20
Floor to top of head (Arch)	DH + 38	DH + 38
Floor to top of head (Grvd)	DH + 49	DH + 49
Floor to underside of head*	DH + 18.5	DH + 18.5

DH = Door Height DW = Door Width  
\* = Same calculations for both Architrave (Arch) & Grooved (Grvd) jambs  
Note: All dimensions are in millimetres

### Trim sizes

Single		Bi-Parting	
Door size	Trim size	Door size	Trim size
1980 x 610	2075 x 1250	1980 x 610	2075 x 2450
1980 x 660	2075 x 1350	1980 x 660	2075 x 2650
1980 x 710	2075 x 1450	1980 x 710	2075 x 2850
1980 x 760	2075 x 1550	1980 x 760	2075 x 3050
1980 x 810	2075 x 1650	1980 x 810	2075 x 3250
1980 x 860	2075 x 1750	1980 x 860	2075 x 3450
1980 x 910	2075 x 1850	1980 x 910	2075 x 3650

### Standard CS SlimSlider Features

- Trim height**
- Trim width**
- Lintel** (part of wall framing).
- Closing jamb**  
Always quoted as standard.  
Can be omitted if not needed.
- Jambs**  
Available as:
  - flat jambs ready for architraves or
  - grooved (rebated), ready for wall linings. Jamb are designed for 10mm linings only.
- Track in one piece**  
Heavy-duty aluminium.
- Back stud**  
Strong and made of reliable, heavy-duty aluminium.
- Split jambs**  
Extruded aluminium split jambs for strength; etch primed, ready for painting.
- Skirting blocks**  
Fitted on either side of the bottom plate, to fix both linings and skirting.

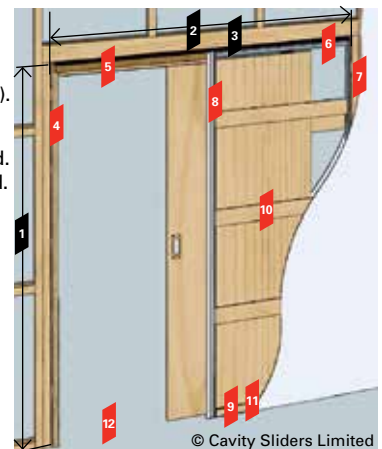

© Cavity Sliders Limited

- Pine nogs**  
Fitted on both sides and offset for adjacent wall fixing. Extra nogs are available if more fixing is required.
- Bottom plate**  
One-piece in aluminium.
- No visible floor track or guide**  
A hidden T-guide at the base of the cavity pocket guides the door through opening.

**Cavity Sliders Limited**  
Auckland Head Office  
5 - 7 Rakino Way  
Mt Wellington  
PO Box 112349, Penrose  
Auckland 1642, NZ  
T 09 276 0800  
F 09 276 2525  
info@csfordoors.co.nz

[www.csfordoors.co.nz](http://www.csfordoors.co.nz)  
Bay of Plenty / Waikato  
40 Newton Street  
Mt Maunganui  
T 07 928 0800  
F 07 928 2525  
salesbop@csfordoors.co.nz

[info@csfordoors.co.nz](mailto:info@csfordoors.co.nz)  
Wellington  
33 Grenada Business Park  
16 Jamaica Drive  
Grenada North  
T 04 473 9994  
F 04 473 9995  
saleswgt@csfordoors.co.nz

A division of:  
**CS GROUP**  
Innovative door solutions

Christchurch  
6 Marylands Place, Middleton  
T 03 348 6158  
F 03 348 6150  
saleschch@csfordoors.co.nz