



Performance is everything.™

Spray & Vac Window Cleaner Range

Let's get started



VX11

**1 year
warranty**

Let's talk safety



Basic safety precautions

This Spray & Vac is intended for household use only and NOT for commercial or industrial use.

When using the Spray & Vac basic safety precautions should always be observed, including the following:

- Keep fingers, hair and loose clothing from moving parts and openings whilst using the Spray & Vac
- This appliance is not intended for use by persons (including children) with reduced physical, sensory or mental capabilities or lack of experience and knowledge unless they have been given supervision or instruction concerning use

of the appliance in a safe way and understand the hazards involved. Children shall not play with the appliance.

Cleaning and user maintenance shall not be made by children without supervision

- Keep the charger in a dry place and use indoors only
- Only Vax recommend charger, accessories and solution should be used with this Spray & Vac

Please keep instructions for future reference and use the Spray & Vac only as instructed in this guide



Don'ts

This Spray & Vac is intended for indoor use only and NOT for outdoor use.

- ✗ Don't use this Spray & Vac if it has been dropped, damaged, immersed in water or left outdoors
- ✗ Don't unplug the Spray & Vac or pull the Spray & Vac by the charger cord. Don't use the charger cord as a handle, pull the charger cord around corners or sharp edges or close a door over the charger cord
- ✗ Don't charge the Spray & Vac if the Charger cord or plug is damaged. Please contact the Vax Careline on AU 1300 361 505 / NZ 0800 800 900 or visit www.vax.com.au/www.vax.co.nz Keep the cord away from heated surfaces
- ✗ Don't use the Spray & Vac charger with incorrect voltage as this may result in damage or injury to the user. The correct voltage is listed on the rating label on the base of the machine.
- ✗ Don't handle the plug or use the Spray & Vac with wet hands

- ✗ Don't use the Spray & Vac whilst connected to the charger unit
- ✗ Don't throw the Spray & Vac into fire or expose to high temperatures, as the Spray & Vac contains a rechargeable battery which may cause damage or burst. Never dismantle the battery or replace with a different type
- ✗ Don't attempt to remove blockages with sharp objects as this may cause damage to your Spray & Vac
- ✗ Don't vacuum up hot coals, cigarette butts, ash, matches or smoking hot burning items or use in an area where there may be harmful fluids (chlorine, bleach, and ammonia drain cleaner)
- ✗ Do not vacuum hard or sharp objects such as glass, nails, screws or coins etc
- ✗ Don't vacuum plaster dust, concrete dust or any other building or vitreous material
- ✗ Do not vacuum flour, baking soda or any other powder-based carpet refresher or deodoriser



Do's

- ✓ Only use the Spray & Vac indoors on vertical surfaces
- ✓ Always make sure the **solution tanks** are fitted correctly before using your Spray & Vac
- ✓ Turn off all controls on the Spray & Vac before disconnecting or connecting the charger
- ✓ Always protect the charger cable from heated surfaces or near open flames

- ✓ Use only SAA approved 10amp extension cords, non-approved extension cords may overheat
- ✓ Always charge the Spray & Vac indoors
- ✓ Always carry the Spray & Vac by the handle
- ✓ Store your Spray & Vac in a cool, dry area away from children
- ✓ Only use Vax recommended batteries and solution

Thank you for buying this Spray & Vac

Taking care of your windows

The Spray & Vac Window Cleaner is designed to clean windows regularly as effectively and efficiently as possible and this user guide will help you get the most out of your machine.

Clean windows look better and make your home brighter.

Taking care of your Spray & Vac

Also inside this guide are instructions on maintaining your new machine, so that it's always ready when you are to tackle your windows.

We're here if you need us

For troubleshooting simply visit or call:

Australia: 1300 361 505*

vax.com.au

New Zealand: 0800 800 900*

vax.co.nz

*Monday – Friday: 8:30am -5:00pm

Calls are charged at the standard local rate. Please make note of the serial number and model number of the product before calling.



Performance is everything.™

Contents

Let's talk safety

Getting to know your machine

Getting started

Using your machine

Taking care of your machine

What to do if it goes wrong

Getting in touch

Spray & Vac

Included with your machine

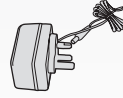

Charger

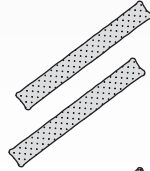

Microfibre pad x 2

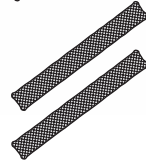

Scrub pad x 2



Vax window solution 120ml x 2

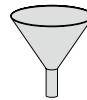

Funnel

Getting to know your machine



Technical Specification

Name **Vax Spray & Vac**

Voltage **3.7V**

Weight **0.8kg**

Runtime **30 minutes**

Charge time **3 hours**

Battery type **Lithium-ion**

Battery capacity **1500mAh**

Charger model **KSA34A0550060VAD**

Charger input **100-240V-50/60Hz 0.15A**

Charger output **5.5V 0.6A**

Getting started

PLEASE READ 'LET'S TALK SAFETY' AT THE BEGINNING BEFORE USE

Assembling your window vacuum

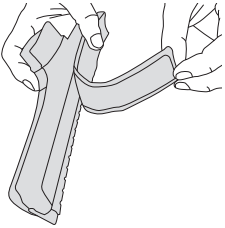

Choose microfibre/scrub pad and push onto the fastening strip located on the suction head

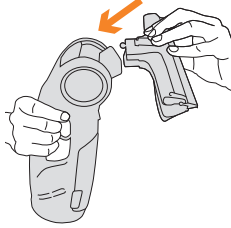

Insert the suction head into the machine and push until it clicks into place

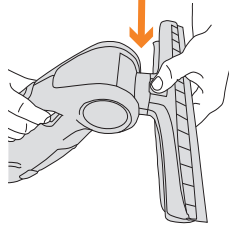

To remove the suction head, press the suction head release button and gently pull the suction head away from the machine



Note: The microfibre pad is for general cleaning and the scrub pad for cleaning stubborn marks

Using your machine

Using your window vacuum



Insert the charger cable into the power charger connector. Plug the charger into the mains. The power charger indicator light will flash during charging and when fully charged the indicator light will show solid red. The Spray & Vac will need to charge for 3 hours

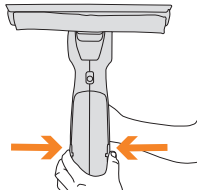

Squeeze the tank release buttons to remove the dual tank from the machine

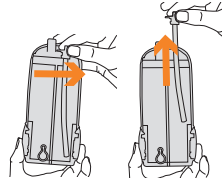

Turn the lid of the cleaning solution tube anticlockwise and lift to remove

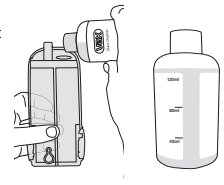

Pour 40ml of Vax window solution into the cleaning solution side of the dual tank

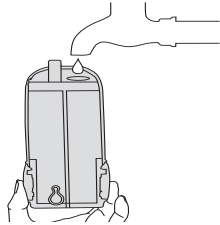

Top up with water (Max 35°C) to MAX line on solution side of the dual tank and turn the cap clockwise to close

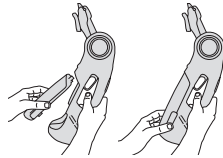

To attach the dual tank back onto the unit, insert top first and gently push the bottom until it fastens into place

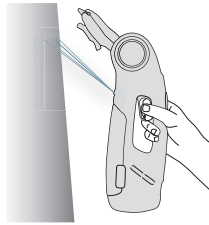

Pull the trigger to spray solution onto the surface to be cleaned

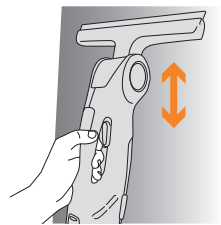

Wipe/scrub the surface with the microfibre or scrub pad on the suction head

Note: You may need to press the trigger a few times first before solution is dispensed, this clears air from the system

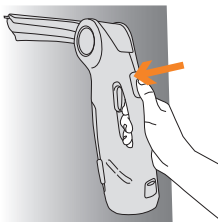

Turn the Spray & Vac on using the power on/off button

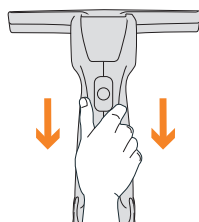

Vacuum up the water using slow, straight strokes

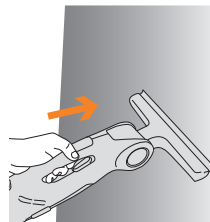

When you reach the bottom of the window, apply pressure and the suction head will pivot

Note: Only use the window vacuum on vertical surfaces

Taking care of your machine

Note: The Spray & Vac must be emptied after each use – DON'T store water/solution in the machine between usage

After every use

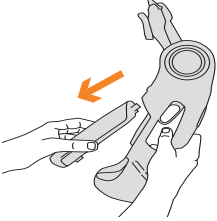

Squeeze the tank release buttons to remove the tank from the Spray & Vac

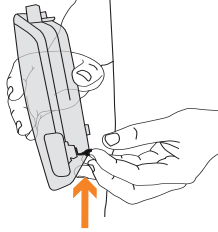

Lift the emptying cap to let the dirty water out of the tank

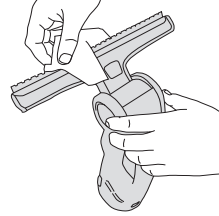

Wipe the squeegee with a damp cloth to remove any excess water

Cleaning the removable squeegee

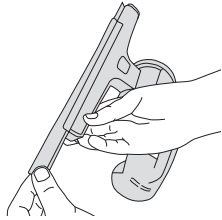

To remove the squeegee, pull and slide through the suction head

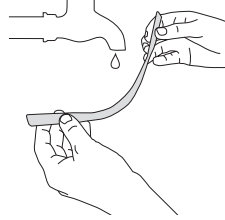

Wash the squeegee under running water (Max 40°C) to remove dirt and debris. Let it dry

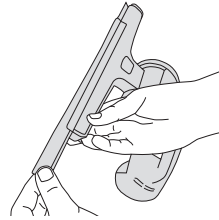

To attach the squeegee push and slide through the suction head

Taking care of your machine

Note: Replacement batteries have not been included with the machine. For replacement batteries please contact Vax Careline on (AU) 1300 361 505 (NZ) 0800 800 900 or visit vax.com.au /vax.co.nz Then follow the instructions below.

Replacing the battery

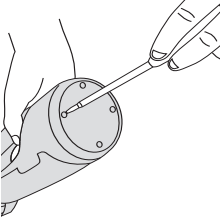

Using a crosshead screwdriver, remove the 4 screws at the base of the unit and remove the base cover

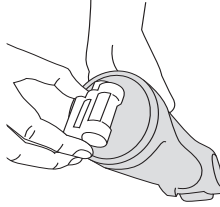

Lift the battery cradle out of the unit

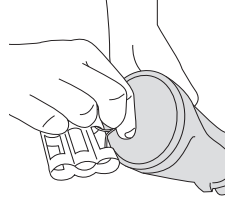

Pinch the release catch to remove the battery cradle

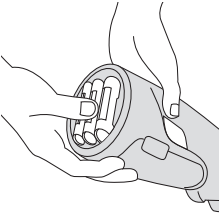

Clip the new battery cradle from Vax into place and insert into the unit

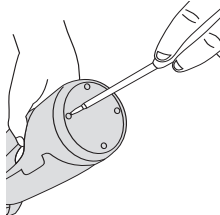

Replace the base cover and replace all screws back in place

What to do if it goes wrong

Problem

Solution

Why won't the window vacuum turn on?

- The battery may not be charged. Connect the charger. The indicator light will flash red when charging and show a solid red light when fully charged. The initial charge should be for 3 hours
- The unit might be plugged in. The window vacuum will not run when the charger is plugged in. Remove unit from charger to operate

Why won't the window vacuum pick up?

- The squeegee blade may be blocked. Remove from the machine, rinse and clear any dirt/debris
- The window vacuum may be low on charge. Plug the window vacuum in to recharge
- The dual tank may be full, empty the dual tank

Why does my window vacuum leak?

- You may be using the window vacuum on a flat, horizontal surface. Only use the window vacuum on vertical surfaces
- The dual tank may be full, empty the dual tank

Why does my window vacuum leave a smear on my window?

- The squeegee blade is dirty, detach and clean. Go to 'Taking care of your machine'

Why won't the battery recharge?

- The charger may not be inserted correctly
- Check the mains power is switched on
- The electrical outlet may not be working

Warning: Always turn off and unplug the Spray and Vac before carrying out and maintenance/troubleshooting checks

Taking care of you

We're here if you need us. For trouble shooting, simply call or visit:

Australia: 1300 361 505*

vax.com.au

New Zealand: 0800 800 900*

vax.co.nz

*Monday-Friday 8.30am to 5.00pm



Performance is everything.™

Distributed by Techtronic Industries Australia Pty. Ltd.
31 Gilby Road, Mt Waverley, VIC 3149 Australia.
Careline AU: 1300 361 505 www.vax.com.au
Careline NZ: 0800 800 900 www.vax.co.nz