

Homelite®

HBLT25CD



Important!

It is essential that you read the instructions in this manual before assembling, operating, and maintaining the product.

Subject to technical modifications.

Safety, performance, and dependability have been given top priority in the design of your grass trimmer.

INTENDED USE

The grass trimmer is intended to be used only by adults who have read and understood the instructions and warnings in this manual and can be considered responsible for their actions.

The product is only intended for use outdoors in a well-ventilated area. For safety reasons, the product must be adequately controlled by a two-handed operation.

The product is designed for cutting grass, light weeds, and other similar vegetation at or about ground level. The cutting plane should be approximately parallel to the ground surface.

The product should not be used to cut or trim hedges, bushes, or other vegetation where the cutting plane is not or about ground surface level.

Do not use the product for any other purpose.

⚠ WARNING

To reduce the risk of injury, the user must read and understand the operator's manual.

⚠ WARNING

Do not attempt to operate the product until you have read thoroughly and understood completely all instructions and safety rules contained in this manual. Failure to comply may result in accidents involving fire, electric shock, or serious personal injury. Save the operator's manual and review frequently for continuing safe operation, and instructing others who may use the product.

⚠ WARNING

The product is not intended to be used by children or persons with reduced physical, mental, or sensory capabilities. Children should be adequately supervised to ensure they do not play with the product.

GENERAL SAFETY WARNINGS

- For safe operation, read and understand all instructions before using the product. Follow all safety instructions. Failure to follow all safety instructions listed below can result in serious personal injury.
- Some regions have regulations that restrict the use of the product. Check with your local authority for advice.
- Do not allow children or untrained individuals to use the product.
- Do not start or run the engine in a closed or poorly ventilated area; breathing exhaust fumes can kill.
- Clear the work area before each use. Remove all objects such as rocks, broken glass, nails, wire, or string that can be thrown or become entangled in the string head.
- Wear full eye and hearing protection while operating the product. If working in an area where there is a risk of falling objects, head protection must be worn.
- Hearing protection may restrict the operator's ability to hear warning sounds. Pay particular attention to potential hazards around and inside the working area.
- Wear heavy, long trousers, non-slip protective footwear, and gloves. Do not wear loose fitting clothing, short trousers, jewellery of any kind, or use with bare feet.
- Secure long hair so it is above shoulder level to prevent entanglement in any moving parts.
- Keep all bystanders, children, and pets at least 15 m away. Stop the product if anyone enters the area.
- Do not use the product when tired, ill, under medication, or under the influence of alcohol and drugs.
- Do not use in poor lighting. The operator needs clear unobstructed vision to identify potential hazards.
- Keep firm footing and balance at all times. Do not overreach. Overreaching can result in loss of balance or exposure to hot surfaces.
- Keep all parts of your body away from any moving part.
- Do not touch the area around the silencer or cylinder of the product, these parts get hot from operation.
- Always stop the engine and allow it to cool down before making any adjustments.
- Do not smoke when mixing the fuel or when filling the fuel tank.
- Mix and store the fuel in a container that is approved for fuel.
- Mix the fuel outdoors where there are no sparks or flames. Wipe up any fuel spillage. Move 9 m away from refueling site before starting engine.
- Stop the engine and allow it to cool down before refueling or storing the product.
- Allow the engine to cool down, empty the fuel tank, and secure the product from moving before transporting in a vehicle.
- Switch off the engine. Make sure all moving parts have come to a complete stop:
 - before servicing
 - before leaving the product unattended
 - before clearing a blockage
 - before checking, cleaning, and working on the product
 - before changing accessories
 - after striking a foreign object
 - whenever performing maintenance
 - whenever the product starts to vibrate abnormally

WARNING

Never use cutting means or attachments, which are not specified by HOMELITE in this manual. This includes the use of metal multi-piece pivoting chains and flail-blades. These items are known to break up during use and present a high risk of serious injury to the operator or bystanders.

WARNING

Inspection after dropping or other impacts: Thoroughly inspect the product and identify any problems or damage to it. Any part that is damaged should be properly repaired or replaced by an authorised service centre.

GRASS TRIMMER SAFETY WARNINGS

- Replace the string head if cracked, chipped, or damaged in any way. Be sure the string head is properly installed and securely fastened. Failure to do so can cause serious injury.
- Avoid using on wet grass.
- Do not walk backwards when using the product.
- Walk, never run.
- The small blade fitted to the cutting attachment guard is designed to trim the new extended line to the correct length for safe and optimum performance. It is very sharp; do not touch it, particularly when cleaning the product.
- Always ensure that ventilation openings are kept clear of debris.
- Before use and after any impact, check that there are no damaged parts. Examine the cutting means for signs of cracking or other damage. A defective switch or any part that is damaged should be properly repaired or replaced by an authorised service facility.
- Make sure the head attachment is properly installed and securely fastened.
- Make sure all guards, deflectors, handles, bolts, and fasteners are properly and securely attached.
- Do not modify the product in any way. This may increase the risk of injury to yourself or others.
- Use only the manufacturer's replacement line in the cutting head. Do not use any other cutting attachment.
- Do not operate the product without the cutting attachment guard in place. Ensure the cutting attachment is in good condition.
- Maintain a firm grip on both handles while trimming. Keep string head below waist level. Never cut with the string head located more than 76 cm above the ground.

TRANSPORTATION AND STORAGE

- Stop the engine and allow it to cool down before storing or transporting.
- Clean all foreign materials from the product.

- Drain all fuel from tank into a container approved for petrol. Remember to properly replace and tighten the fuel cap.
- Run the engine until it stops, this will remove all fuel that could become stale and leave varnish and gum in the fuel system.
- Drain all lubricant from tank into a container approved for lubricant. Remember to properly replace the lubricant cap.
- Store the product in a cool, dry, and well-ventilated place that is inaccessible to children. Keep away from corrosive agents, such as garden chemicals and de-icing salts. Do not store outdoors.
- When transporting the product in a vehicle, secure it against movement or falling to prevent injury to persons or damage to the product.
- Never carry or transport the product while the engine is running.
- Abide by all government and local regulations for the safety storage and handling of petrol.

Short term

- Stop the engine, and allow it to cool down before storing.
- Clean all foreign material from the product.
- Store the product in a cool, dry, and well-ventilated place that is inaccessible to children.
- Keep away from corrosive agents such as garden chemicals and de-icing salts.
- Do not store outdoors.

MAINTENANCE

WARNING

Use only original manufacturer's replacement parts, accessories, and attachments. Failure to do so can cause possible injury, contribute to poor performance, and may void your warranty.

- Always stop the engine and allow it to cool down before making any maintenance.
- You may make adjustments and repairs described in this manual. For other repairs, contact an authorised service centre.
- Consequences of improper maintenance may include excess carbon deposits resulting in loss of performance and discharge of black lubricant residue dripping from the silencer.
- For the replacement line, use only nylon filament line of the diameter described in the specification table of this manual.
- After extending the new cutter line, always return the product to its normal operating position before starting.
- After each use, clean the product with a soft, dry cloth.

- Any part that is damaged should be properly repaired or replaced by an authorised service centre.
- Check all nuts, bolts, and screws at frequent intervals for proper tightness to ensure the product is in a safe working condition.

RESIDUAL RISK

Even when the product is used as prescribed, it is still impossible to completely eliminate certain residual risk factors. The following hazards may arise in use and the operator should pay special attention to avoid the following:

- Injury caused by vibration
 - Hold the product by designated handles and restrict working time and exposure.
- Exposure to noise can cause hearing injury
 - Wear hearing protection and limit exposure.
- Eye injury due to flying debris
 - Wear eye protection at all times.

RISK REDUCTION

It has been reported that vibrations from handheld tools may contribute to a condition called Raynaud's Syndrome. Symptoms may include tingling, numbness and blanching of the fingers, usually apparent upon exposure to cold. Hereditary factors, exposure to cold and dampness, diet, smoking and work practices are all thought to contribute to the development of these symptoms. There are measures that can be taken by the operator to possibly reduce the effects of vibration:

- Keep your body warm in cold weather. When operating the product, wear gloves to keep the hands and wrists warm. It is reported that cold weather is a major factor contributing to Raynaud's syndrome.
- After each period of operation, exercise to increase blood circulation.
- Take frequent work breaks. Limit the amount of exposure per day.

If you experience any of the symptoms of this condition, immediately discontinue use and see your physician.

⚠ WARNING

Injuries may be caused, or aggravated, by prolonged use of a tool. When using any tool for prolonged periods, ensure you take regular breaks.

SYMBOLS



Safety alert



Please read the instructions carefully before starting the product.



Wear eye, hearing, and head protection when operating the product.



Beware of thrown or flying objects. Keep all bystanders, especially children and pets, at least 15 m from the operating area.



Wear non-slip safety footwear when using the product.



Wear non-slip, heavy duty gloves.



Do not use blade(s) on the product.



Rotational speed and maximum speed of the shaft for the cutting attachment.



PRIME - press the primer bulb 10 times slowly.



Run position



Half choke position



Full choke position

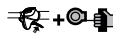

Squeeze the trigger and pull the starter grip.



Keep hands away from blades.



To reduce the risk of injury or damage, avoid contact with any hot surface.



Use 2-stroke lubricant for air cooled engines.



Use unleaded petrol intended for motor vehicle use with an octane rating of 91 ((R+M)/2) or higher.



The bystander sound pressure level is 76.3 dB(A) per ANSI B175.3.

Original instructions | English



Wait for 10 seconds.



Regulatory Compliance Mark (RCM).
Product meets applicable regulatory requirements.



Handle position

The following signal words and meanings are intended to explain the levels of risk associated with this product.

⚠ DANGER

Indicates an imminently hazardous situation, which, if not avoided, will result in death or serious injury.

⚠ WARNING

Indicates a potentially hazardous situation, which, if not avoided, could result in death or serious injury.

⚠ CAUTION

Indicates a potentially hazardous situation, which, if not avoided, may result in minor or moderate injury.

CAUTION

Without safety alert symbol

Indicates a situation that may result in property damage.

ASSEMBLY

UNPACKING

The product requires assembly.

- Carefully remove the product and any accessories from the box. Make sure that all items listed in the packing list are included.
- Inspect the product carefully to make sure no breakage or damage occurred during shipping.
- Do not discard the packing material until you have carefully inspected and satisfactorily operated the product.
- If any parts that require assembly have already been assembled, return the product to the supplier.

PACKING LIST

- Power head and upper boom assembly x 1
- Lower boom with PRO-CUT I string head assembly x 1
- Front handle assembly x 1
- Safety guard assembly x 1
- String line x 5
- 2-stroke lubricant x 1
- Operation manual x 1
- Combination wrench x 1
- Allen wrench x 1

⚠ WARNING

If any parts are damaged or missing, do not operate the product until the parts are replaced. Failure to heed this warning could result in serious personal injury.

⚠ WARNING

Do not attempt to modify the product or create accessories not recommended for use with the product. Any such alteration or modification is misuse and could result in a hazardous condition leading to possible serious personal injury.

⚠ WARNING

Never attach or adjust any attachment while power head is running. Failure to stop the engine may cause serious personal injury.

⚠ WARNING

Be certain the spool retainer is fully tightened before operating the product; check it periodically for tightness during use to avoid serious injury.

ATTACHING THE FRONT HANDLE

- Loosen and remove the bolt and wing nut from the front handle.
- Install the front handle onto the shaft. Position the handle as shown in the label.
- Replace the bolt and wing nut and then tighten the wing nut securely.

ATTACHING THE SAFETY GUARD

- Remove the wing nut and bolt from the safety guard.
- Place the safety guard over the shaft and bracket.
- Install the bolt through the slots in the tabs on safety guard and bracket on driveshaft housing.
- Install the wing nut.
- Tighten securely.

ATTACHING THE STRING LINE IN THE PRO-CUT I HEAD

- Place the middle of the line under the hook/notch inside the spool.
- Feed the ends of the line through the eyelets on the side of the PRO-CUT I fixed line head.
- Pull the line outwards so it is tight and even on both sides of the spool.

CONNECTING THE POWER HEAD SHAFT AND TRIMMER SHAFT**⚠ WARNING**

Do not install, remove, or adjust any attachment while the power head is running. Failure to stop the engine can cause serious personal injury.

- Align the two indentations in the trimmer shaft with the screws in the power head shaft. Insert the trimmer shaft into the power head shaft.
- Push the two sections together until the trimmer shaft stops.
- Using the Allen wrench, turn each of the screws until it is securely tightened.

OPERATION**FUEL AND REFUELING****Handling the fuel safely**

- Always handle fuel with care, it is highly flammable.
- Always refuel outdoors where there are no sparks and flames. Do not inhale fuel vapors.
- Do not let petrol or oil come in contact with your skin.
- Keep petrol and oil away from the eyes. If petrol or oil comes in contact with the eyes, wash them immediately with clean water. If irritation is still present, see a physician immediately.
- Clean up spilled petrol immediately.

Mixing the fuel

- The product is powered by a 2-stroke engine and requires pre-mixing petrol and 2-stroke oil. Store pre-mix unleaded petrol and 2-stroke engine oil in a clean container approved for petrol.
- This engine is certified to operate on unleaded petrol intended for automotive use with an octane rating of 91 $([R + M] / 2)$ or higher.
- Do not use any type of pre-mixed petrol / oil from fuel service stations, this includes the pre-mixed petrol / oil intended for use in mopeds, motorcycles, etc.
- Use synthetic 2-stroke oil only. Do not use automotive oil or 2-stroke outboard oil.
- Mix 2% synthetic 2-stroke oil into the petrol. This is a 50:1 ratio.
- Mix the fuel thoroughly and also each time before fuelling.
- Use in small quantities. Do not mix quantities larger than usable in a 30 day period. Synthetic 2-stroke oil containing a fuel stabilizer is recommended.

Filling the tank

- Clean the surface around the fuel cap to prevent contamination.

- Loosen the fuel cap slowly to release pressure and to keep fuel from escaping around the cap.
- Carefully pour the fuel mixture into the tank. Avoid spillage.
- Prior to replacing the fuel cap, clean and inspect the gasket.
- Immediately replace fuel cap and hand tighten. Wipe up any fuel spillage. Move 9 m away from refueling site before starting engine.

NOTE: It is normal for smoke to be emitted from a new engine during and after first use.

⚠ WARNING

Always shut off the engine before fueling. Never add fuel to a machine with a running or hot engine. Move at least 9 m from refueling site before starting engine. Do not smoke!

**50:1 Petrol to Oil Mixing Chart**

1 Litre	+	20 ml	=	50:1 (2%)
2 Litres	+	40 ml	=	50:1 (2%)
3 Litres	+	60 ml	=	50:1 (2%)
4 Litres	+	80 ml	=	50:1 (2%)
5 Litres	+	100 ml	=	50:1 (2%)

⚠ WARNING

The product may throw objects during operation, causing injury to the operator or to bystanders. Always wear suitable eye protection, long, heavy pants, and boots while operating the product.

STARTING THE PRODUCT

Starting the product differs depending on whether the engine is cold (not yet started today) or warm (has been running in the last hour). Always refer to the Starting Instructions label on the air filter when starting the engine. Refer below for full instructions.

⚠ WARNING





Never start or run the engine inside a closed or poorly ventilated area; breathing exhaust fumes can kill.

NOTE: Before starting the product, make sure the trimmer

Original instructions | English

is lying on a flat and bare surface.

Starting a cold engine:

1. Ensure the switch is in the "I" (ON) position.
2. Press the primer bulb 10 times.
NOTE: After the 7th press, the fuel should be visible in the primer bulb. If not, continue pressing until the fuel is visible.
3. Set the choke lever to  choke position.
4. Squeeze the throttle trigger completely and pull the starter grip until the engine attempts to start. Do not pull the starter grip more than 4 times.
NOTE: Keep the throttle trigger squeezed completely through steps 4 to 7.
5. Set the choke lever to  choke position.
6. Pull the starter grip until the engine starts. Do not pull the starter grip for more than 6 times.
NOTE: If the engine does not start, return to  choke position and repeat the process beginning at step 2.
7. Allow the engine to run for 10 seconds, then set the choke lever to  position.

Starting a warm engine:

1. Ensure the switch is in the "I" (ON) position.
2. Press the primer bulb 10 times.
3. Set the choke lever to  position.
4. Pull the starter grip until the engine attempts to start. Do not pull the starter grip for more than 6 times.
NOTE: If the engine does not start, return to step 2 under "Starting a cold engine".

STOPPING THE PRODUCT

- Release the throttle trigger.
- Hold the engine switch in the "STOP" (OFF) position.

OPERATING THE TRIMMER

Follow these steps to operate the curved shaft trimmer.

- Start the trimmer.
- Hold the trimmer at waist level with your right hand on the rear handle and your left hand on the front handle.
- Place the product on the right side of your body with the engine behind and away from your body.
- Trim the grass and weeds with the line parallel to the ground.

WARNING

Injuries may be caused, or aggravated, by prolonged use of the product. When using any product for prolonged periods, ensure you take regular breaks.

NOTE: Always operate the trimmer at full throttle. Prolonged cutting at partial throttle will result in oil dripping from the silencer.

CUTTING TIPS

Cut tall grass from the top down. This will prevent grass from wrapping around the shaft housing and PRO-CUT I head, which may cause damage from overheating. If grass

becomes wrapped around the PRO-CUT I head, stop the engine, wait for all moving parts to stop, and remove the grass.

WARNING

When servicing, use only original manufacturer's replacement parts. Use of any other parts may create a hazard or cause product damage.

WARNING

Always wear safety goggles or safety glasses with side shields during product operation. If operation is dusty, also wear a dust mask.

WARNING

Before inspecting, cleaning, or servicing the product, shut off the engine and wait for all moving parts to stop. Failure to follow these instructions can result in serious personal injury or property damage.

WARNING

Neglected or poorly conducted maintenance may create additional hazards. Do not attempt to repair or maintain the product if you are not qualified to do so. If in doubt, return to a service centre for professional assistance.

GENERAL MAINTENANCE

Avoid using solvents when cleaning plastic parts. Most plastics are susceptible to damage from various types of commercial solvents and may be damaged by their use. Use clean cloths to remove dirt, dust, lubricant, and grease.

WARNING

Do not at any time let brake fluids, petrol, petroleum-based products, penetrating lubricants, etc., come in contact with plastic parts. Chemicals can damage, weaken or destroy plastic, which may result in serious personal injury.

You can often make adjustments and repairs described in this manual. For other repairs, have the trimmer serviced by a service agent.

REPLACING THE PRO CUT I STRING HEAD AND LINE

- Stop the engine and wait for all moving parts to stop completely.
- Loosen the spool retainer by turning it counterclockwise and then remove the string head.
- Take a new PRO-CUT I string head and a 500 mm length of 2.4 mm thick monofilament pre-cut line.
- Place the middle of the line under the hook/notch inside the spool.

- Feed the ends of the line through the eyelets on the side of the PRO-CUT I fixed line head.
- Pull the line outwards so it is tight and even on both sides of the spool.
- Install the PRO-CUT I head assembly on the drive shaft and then secure with spool retainer.

CLEANING THE AIR FILTER

A dirty air filter will cause starting difficulty, loss of performance, and shorten the life span of the engine. Check the air filter monthly. For best performance, replace the air filter at least once a year.

- Stop the engine.
- Remove the air filter cover by pushing down on the latch with your thumb while gently pulling on the cover.
- Remove the air filter.
- Clean the foam filter element with warm soapy water. Rinse and let dry.
- **NOTE:** If the foam filter element is damaged, it should be replaced.
- Apply a light coat of engine oil to the foam filter element, then squeeze it out.
- Reinstall the air filter.

NOTE: Make sure the filter is seated properly inside the cover. Installing the filter incorrectly will allow dirt to enter the engine, causing rapid engine wear.

- Replace the air filter cover by inserting the slot at the bottom of the air box cover into the latch at the bottom of the air box base; push the air box cover up until it latches securely in place.

⚠ WARNING

Make sure the trimmer head stops rotating when you release the trigger. Contact with a rotating trimmer head could cause personal injury.

CHECKING THE FUEL CAP

⚠ WARNING

A leaking fuel cap is a fire hazard and must be replaced immediately.

The fuel cap contains a non-serviceable filter and a check valve. A clogged fuel filter causes poor engine performance. If performance improves when the fuel cap is loosened, the valve may be faulty or the filter may be clogged. Replace the fuel cap if necessary.

SPARK ARRESTOR

HOMELITE line trimmer (HBLT25CNB) is fitted with a spark arrestor. Please note that it is suggested that the spark arrestor should only be cleaned by a recognized service agent.

REPLACING THE SPARK PLUG

This engine uses a TORCH L7RTC spark plug. Use an exact replacement and replace annually.

Follow these steps to replace the spark plug.

- Stop the engine.
- Remove the spark plug boot.
- Loosen the spark plug by turning it counterclockwise with a combination wrench.
- Remove the spark plug.
- Hand thread the new spark plug, turning it clockwise.
- Tighten with a combination wrench to 22~25 Nm torque or at least 4 turns after finger tight. Do not overtighten.

⚠ CAUTION

Be careful not to cross-thread the spark plug. Cross-threading will seriously damage the engine.

CLEANING THE EXHAUST HOLE OF THE CYLINDER AND INTAKE HOLE OF THE MUFFLER

⚠ CAUTION

Always stop the engine and allow it to cool down before cleaning the exhaust hole.

Make sure the product is in the "off" position.

- Remove the screws on the top and rear portions of the housing counterclockwise.
- Remove the rear housing from the engine.
- Remove the muffler screws counterclockwise, and then remove the muffler cover, muffler, and gasket from the cylinder.
- Use the brush to clean the exhaust hole of the cylinder and intake hole of the muffler.
- Place the gasket, muffler, muffler cover and bolts back to its position. Tighten the screws by turning it clockwise.
- Place the rear housing back to its position. Tighten the screws by turning it clockwise.

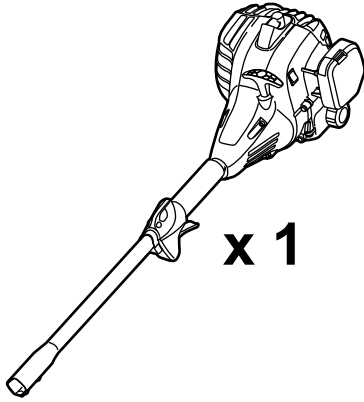

x 1

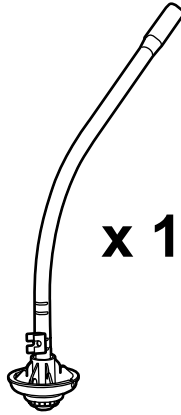

x 1

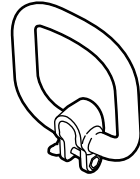

x 1

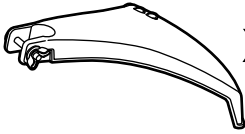

x 1



x 1

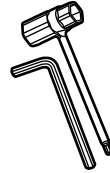

x 1



0.5m

x 5



x 1



1. Ignition module
2. Choke lever
3. Air box cover
4. Fuel cap
5. Rear handle
6. Throttle trigger
7. Muffler

8. Muffler shield
9. Air filter
10. Grass deflector
11. Trimmer head
12. String line
13. Lower shaft
14. Front handle

15. Strap hanger
16. Primer bulb
17. Switch
18. Starter grip
19. Spark plug

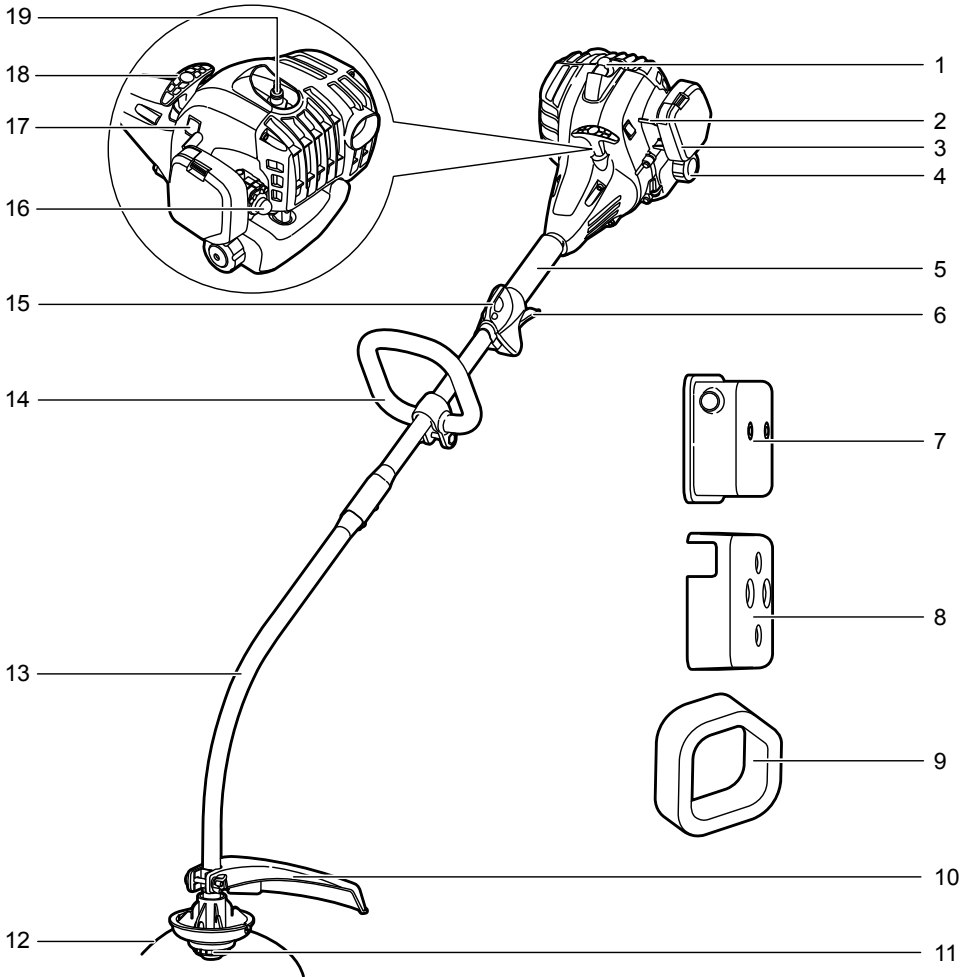

1

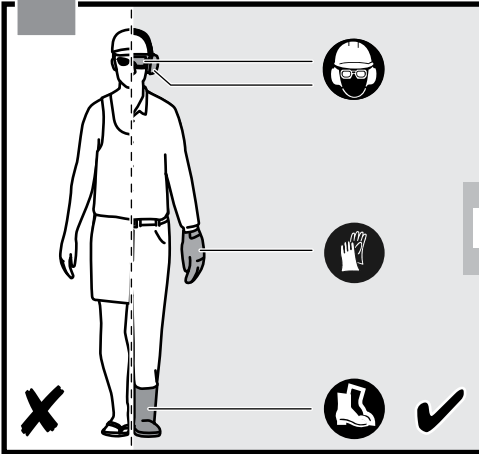

Always wear safety goggles or safety glasses with side shields when operating the product. Failure to do so could result in objects being thrown into your eyes resulting in possible serious injury. When handling the trimmer assembly, wear non-slip, heavy-duty protective gloves. Wear non-skid, protective footwear that will protect your feet and improve your footing on slippery surfaces.

2

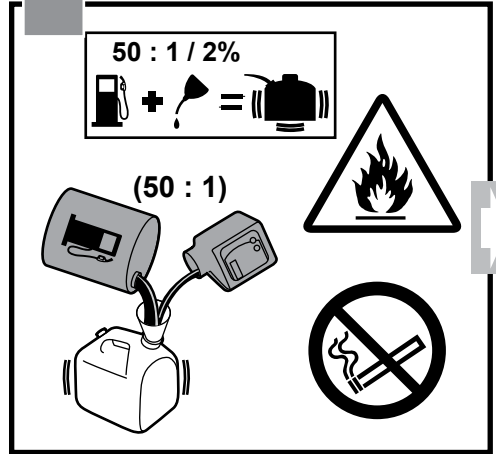

Use synthetic 2-stroke lubricant only. Do not use automotive lubricant or 2-stroke outboard lubricant. Mix 2% synthetic 2-stroke lubricant into the petrol. This is a 50:1 ratio.

5

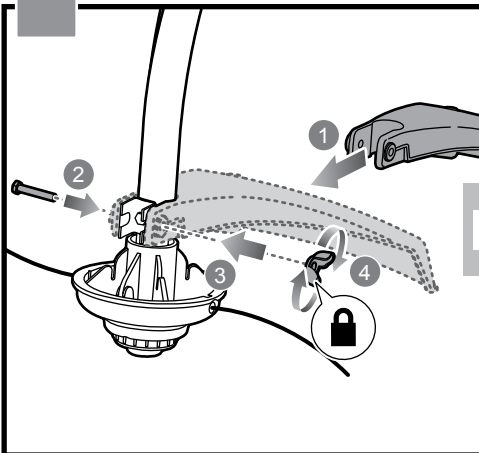

Install the grass deflector.

6

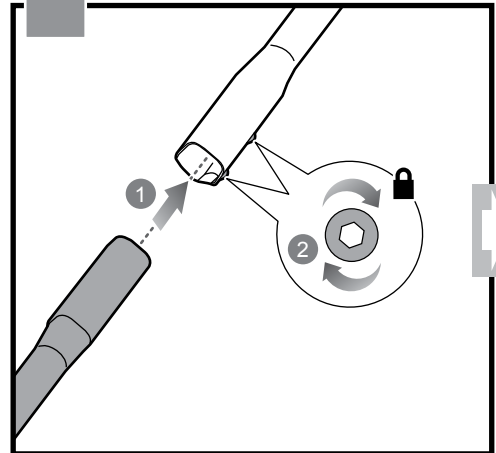

Install the shaft.

3

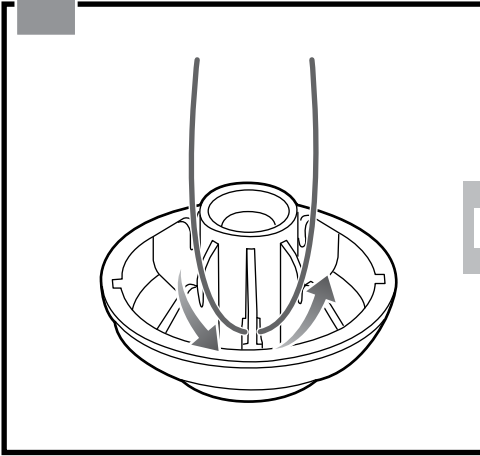

Install the line.

4

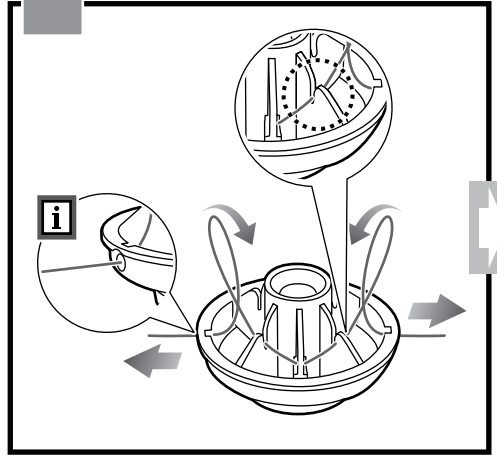

Place the middle of the line under the hook/notch inside the spool.

7

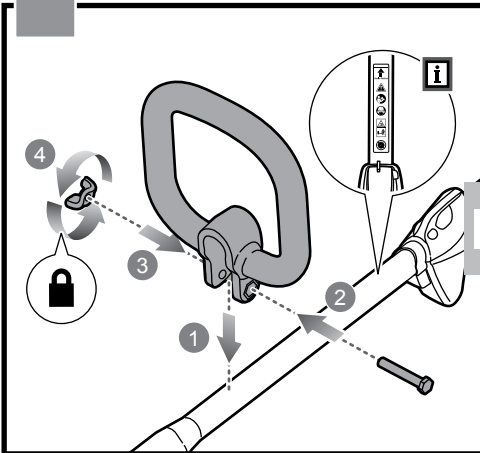

Install the D-handle.

8

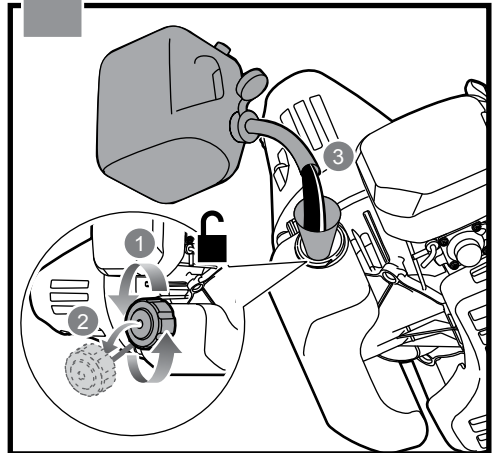

Loosen the fuel cap. Remove the fuel cap. Carefully pour fuel mixture into the tank. Avoid spillage. Immediately replace fuel cap and hand tighten.

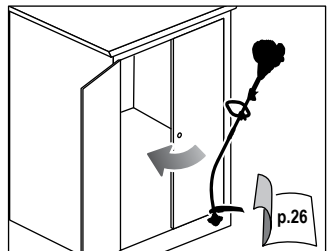
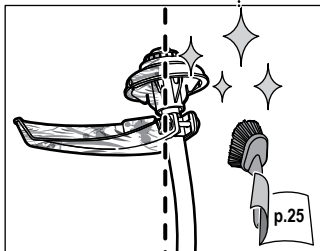
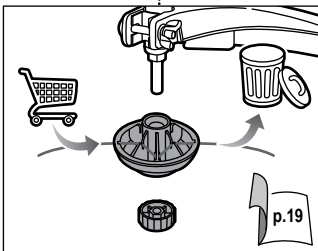
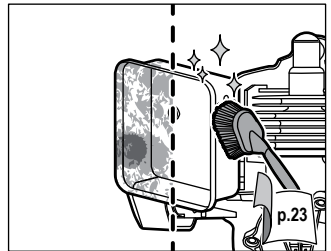
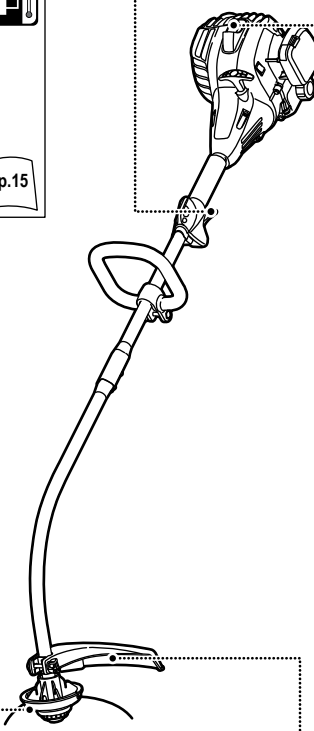
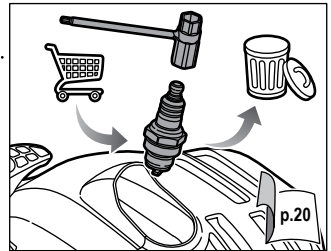
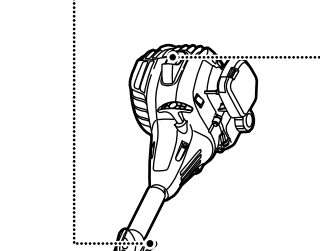
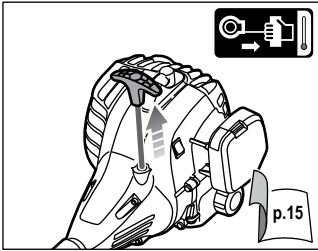
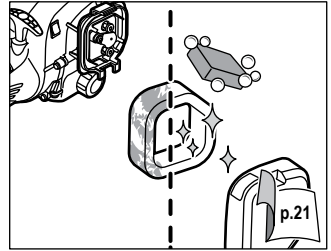
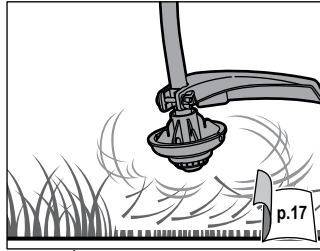
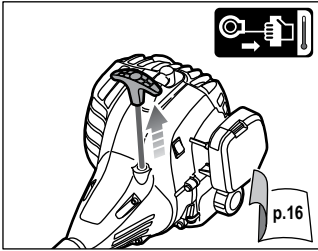

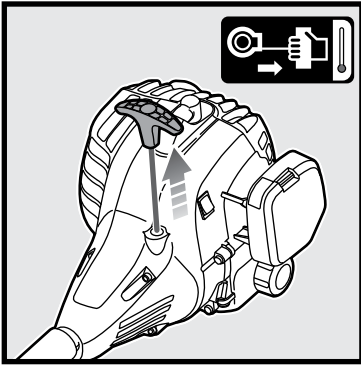

STARTING A COLD ENGINE

1. Lay the product on the ground. Press the primer bulb 10 times.

NOTE: After the 7th press, the fuel should be visible in the primer bulb. If not, continue pressing until the fuel is visible.

2. Set the choke lever to choke position. Squeeze the throttle trigger completely and pull the starter grip until the engine attempts to start. Do not pull the starter grip more than 4 times.
3. Set the choke lever to position. Squeeze the throttle trigger completely and pull the starter grip until the engine starts. Do not pull the starter grip more than 6 times.

NOTE: If the engine does not start, repeat the procedure again from setting the choke lever to choke position.

4. Allow the engine to run for 10 seconds, then set the choke lever to position.

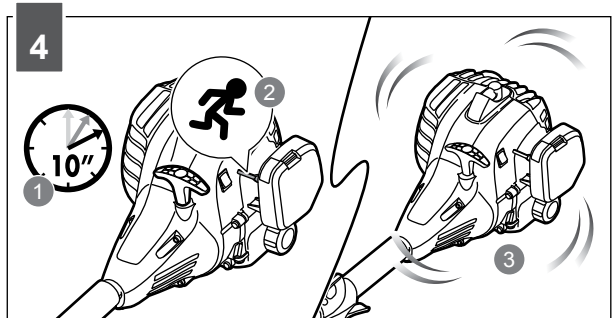
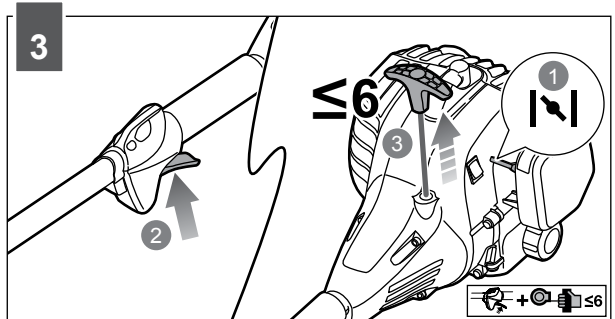
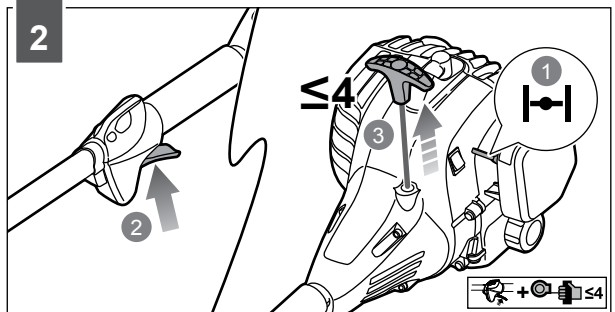
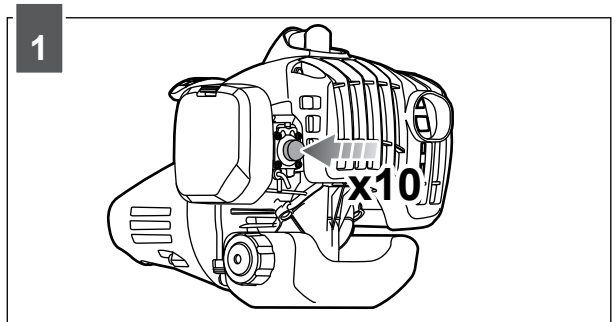

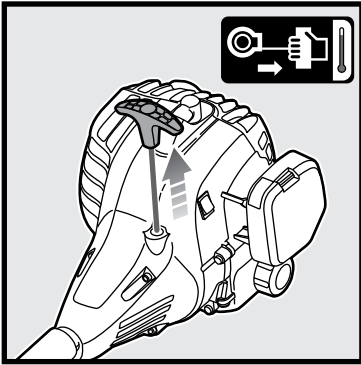

STARTING A WARM ENGINE

1. Lay the product on the ground. Ensure the switch is "I" (ON) position. Press the primer bulb 10 times.
2. Set the choke lever to  position.
3. Pull the starter grip until the engine starts. Do not pull the starter grip for more than 6 times.
4. Allow the engine to run for 10 seconds.

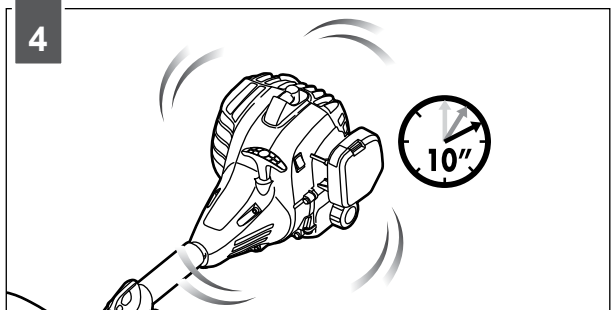
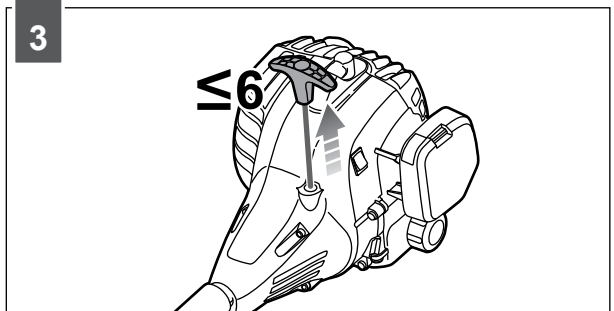
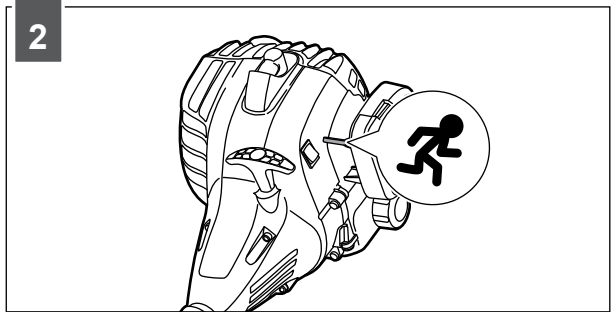
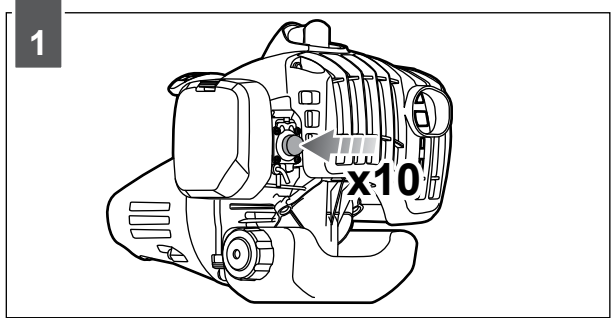

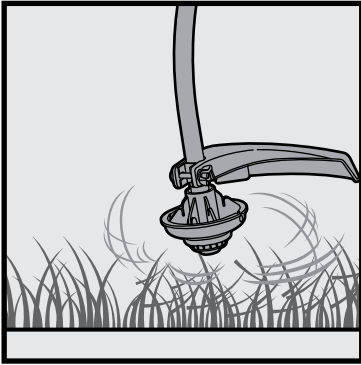

OPERATING THE TRIMMER

NOTE: Hold the product with the right hand on the trigger handle and the left hand on the left handle.

WARNING: Do not cut in a dangerous cutting area. Avoid trees and shrubs. Tree bark, wood mouldings, cladding, and fence posts can easily be damaged by the line.

WARNING: Exercise extreme caution when using the product.

1. To start operating the product, squeeze the throttle trigger.

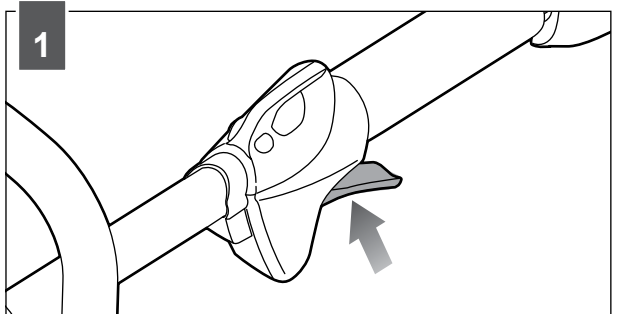
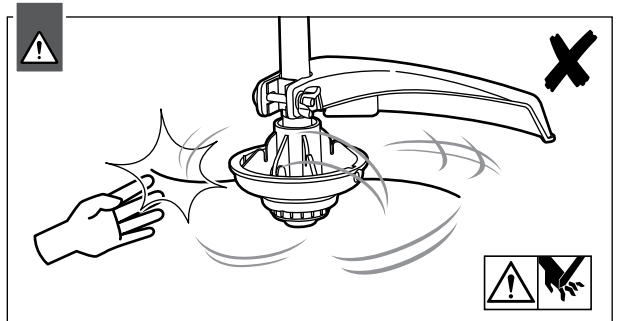
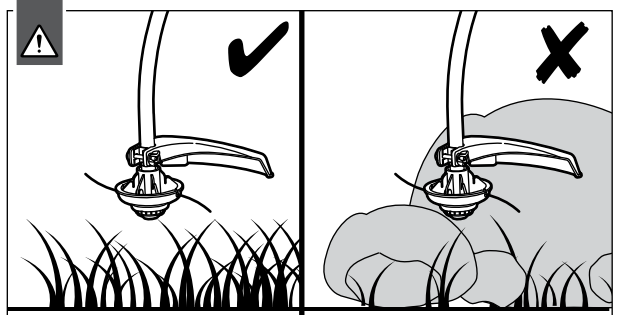
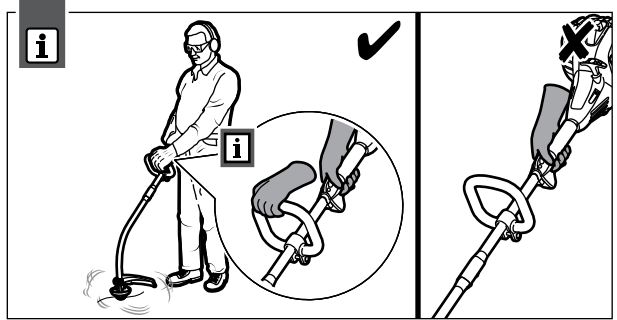

NOTE: The small blade fitted to the cutting attachment guard is designed to trim the new extended line to the correct length for safe and optimum performance. It is very sharp; do not touch it, particularly when cleaning the product.

NOTE: Cut tall grass from the top down. This will prevent grass from wrapping around the shaft housing and bump head, which may cause damage from overheating.

NOTE: For cutting ease and safety, cut the grass from the right side to the left side.

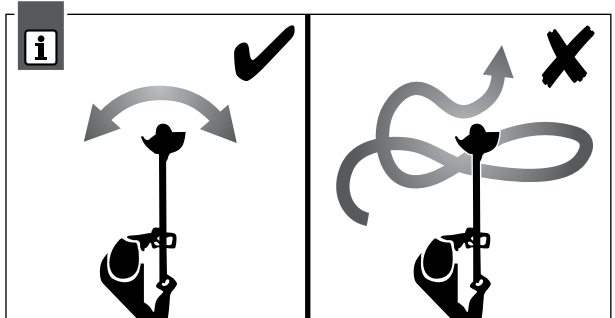
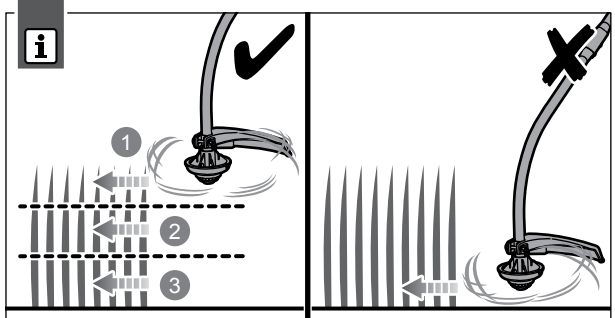
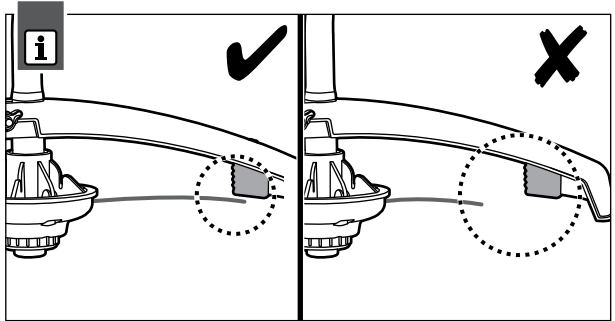
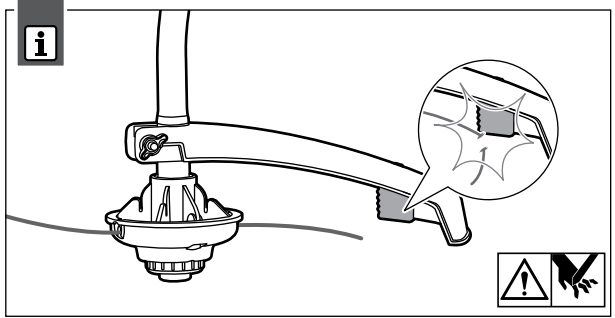

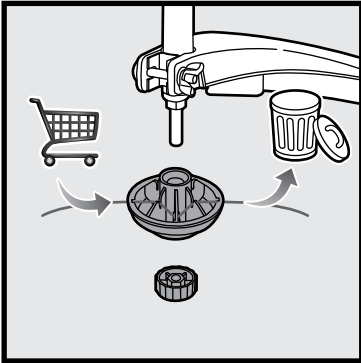

REPLACING THE PRO CUT I STRING HEAD

1. Turn off the product.
2. Loosen the spool retainer by turning it clockwise and then remove the string head.
3. Take a new PRO-CUT I string head and a 0.5 m length of 2.4 mm diameter monofilament pre-cut line. Place the middle of the line under the hook/notch inside the spool. Feed the ends of the line through the eyelets on the side of the PRO-CUT I fixed line head.
4. Pull the line outwards so it is tight and even on both sides of the spool. Install the PRO-CUT I head assembly on the drive shaft and then secure with spool retainer.

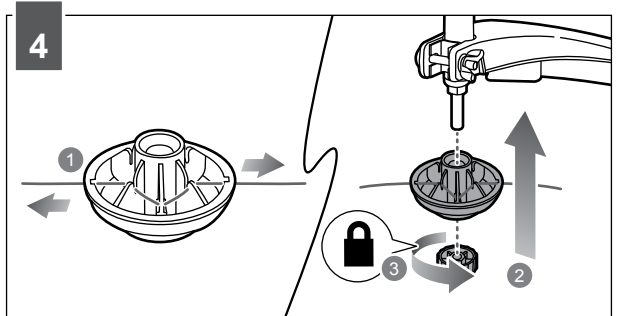
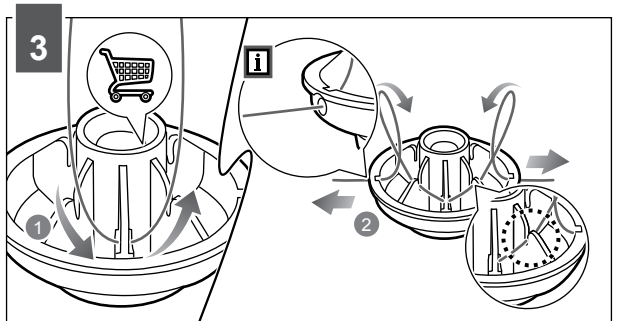
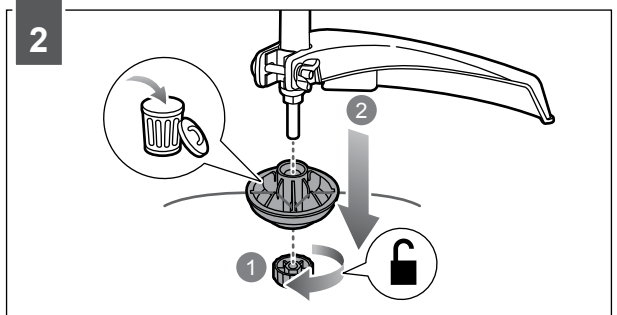
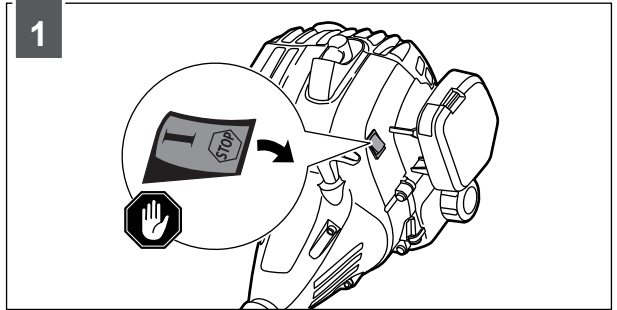

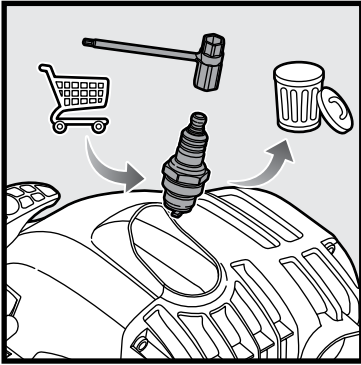

REPLACING THE SPARK PLUG

1. Turn off the product.
2. Twist and pull the rubber protect boot of ignition module, and then remove the old spark plug.
3. Install the new spark plug, tighten by turning it in a clockwise direction or at least 4 turns after finger tight.
4. Assemble back the rubber protect boot.

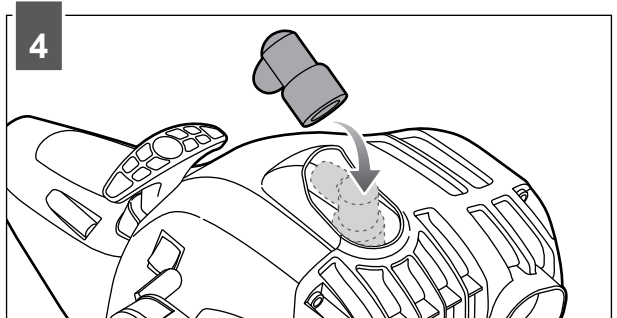
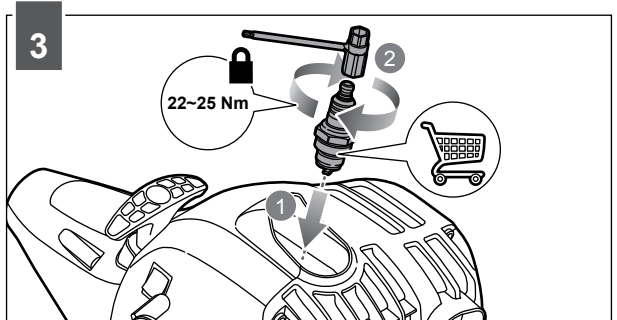
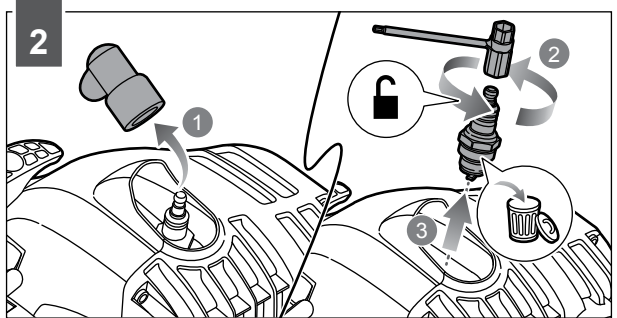
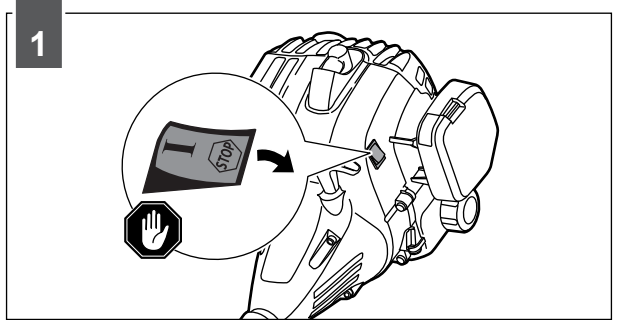

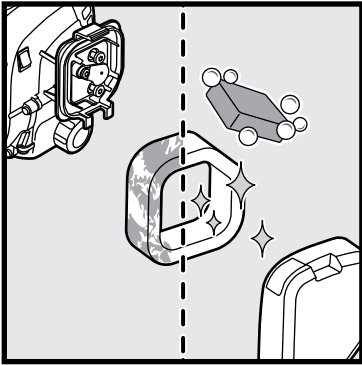

CLEANING THE FILTER

1. Turn off the product.
2. Remove the air filter cover and the air filter.
3. Clean the air filter with warm, soapy water.
4. Rinse, and let the air filter dry completely.

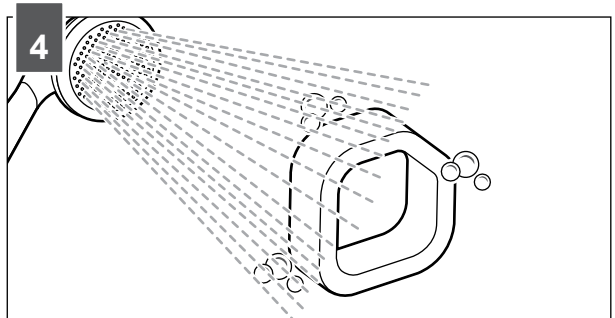
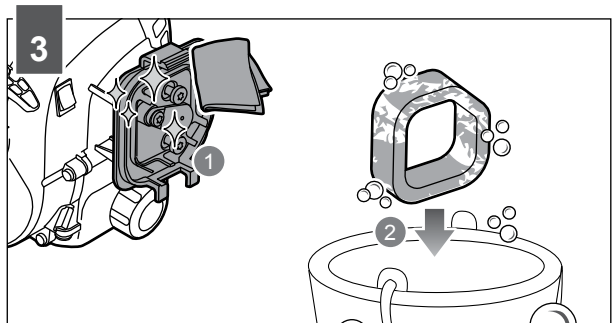
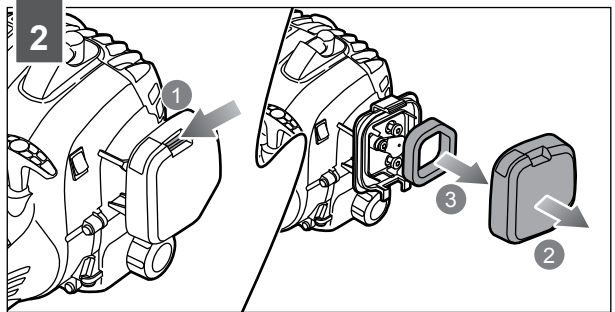
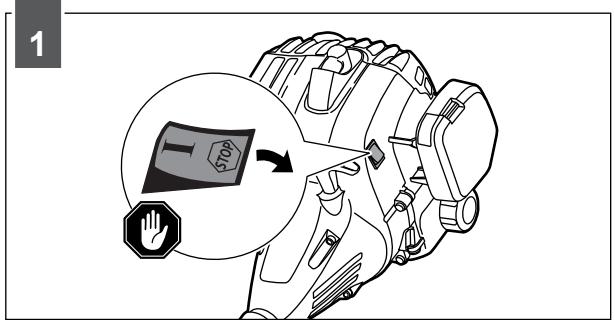

5. Put two drops of lubricant into the air filter. Replace the air filter (fits only one way), and then replace the air filter cover.

NOTE: The air filter should be replaced annually for best performance.

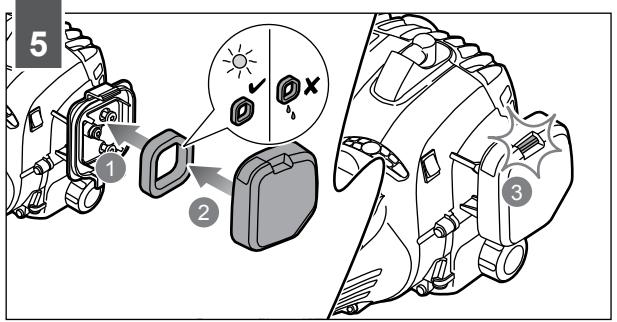

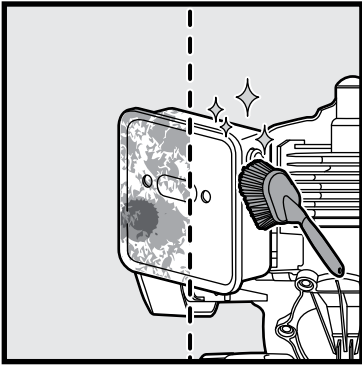

CLEANING THE MUFFLER

1. Turn off the product.
2. Loosen the 4 screws and remove the rear housing.
3. Remove the muffler screws counterclockwise, and then remove the muffler cover, muffler and gasket from the cylinder.
4. Use the brush to clean the exhaust hole of the cylinder and intake hole of the muffler.

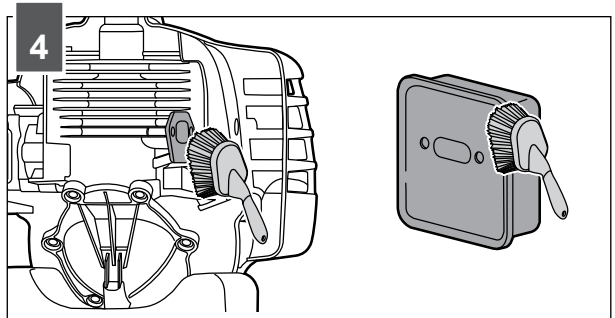
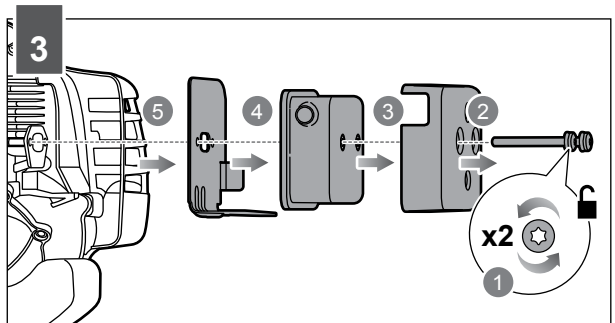
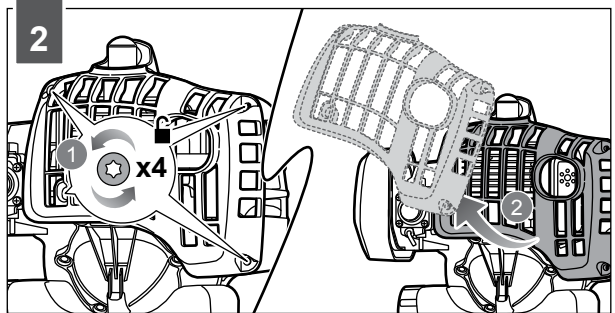
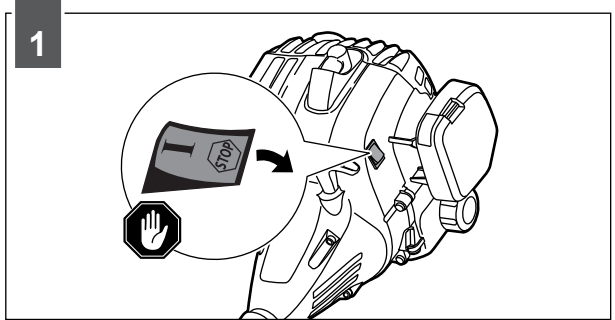

5. Place the gasket, muffler, muffler cover and bolts back to its position. Tighten the screws by turning it clockwise.
6. Place the rear housing back to its position. Tighten the screws by turning them clockwise.

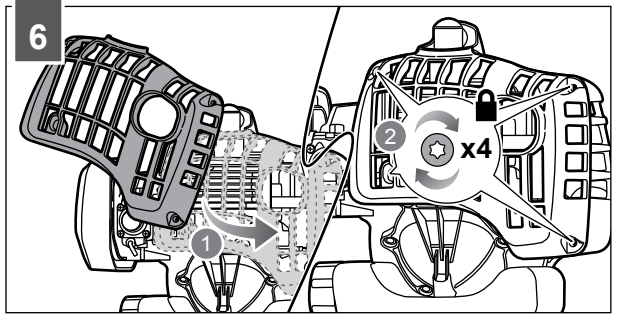
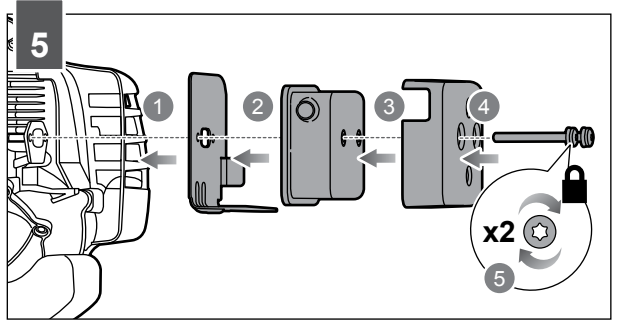

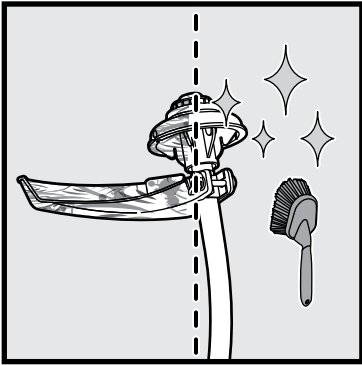

CLEANING THE PRODUCT

1. Turn off the product, and allow it to cool down before cleaning.
2. Clean all foreign material from the product.

WARNING: Keep away from corrosive agents such as garden chemicals and deicing salts.

WARNING: The small blade fitted to the cutting attachment guard is designed to trim the new extended line to the correct length for safe and optimum performance. It is very sharp; do not touch it, particularly when cleaning the product.

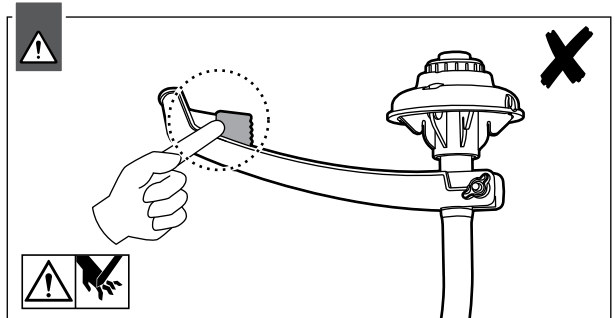
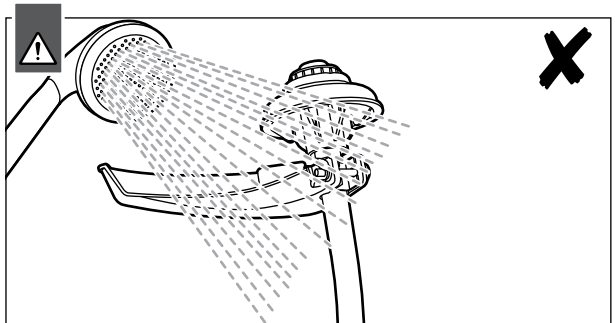
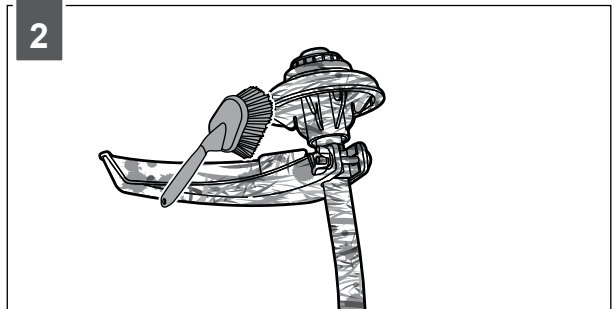
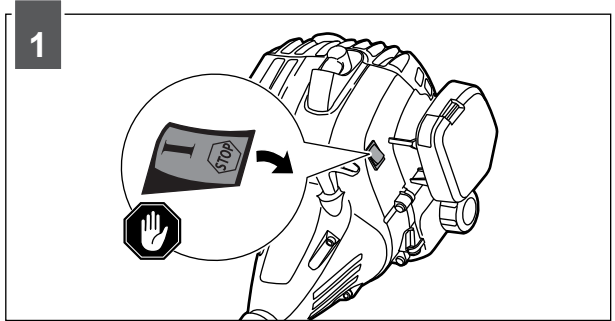

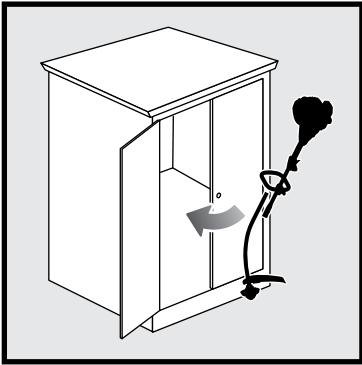

STORING THE PRODUCT

1. Turn off the product, and allow it to cool down before storing the product.

NOTE: Make sure to clean the product before storing.

2. Drain all fuel from tank into a container approved for petrol. Remember to properly replace and tighten the fuel cap.
3. Remove the upper shaft from the handle.

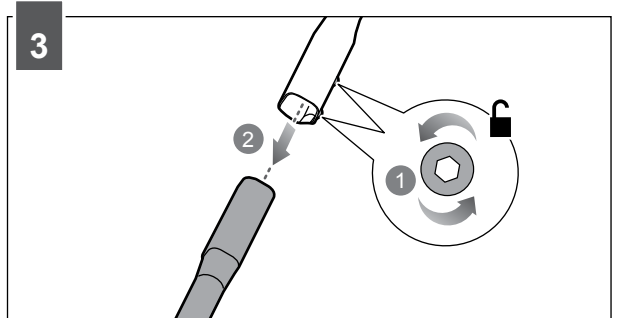
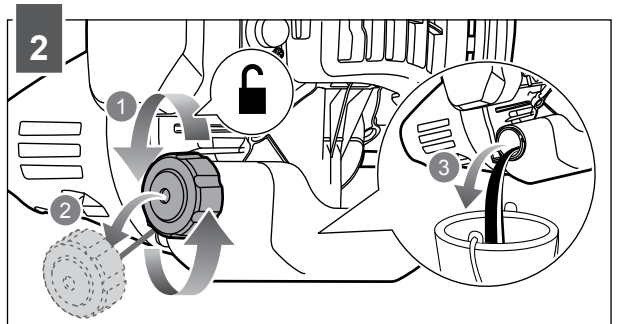
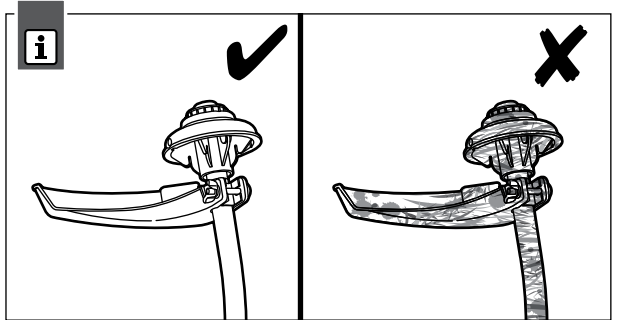
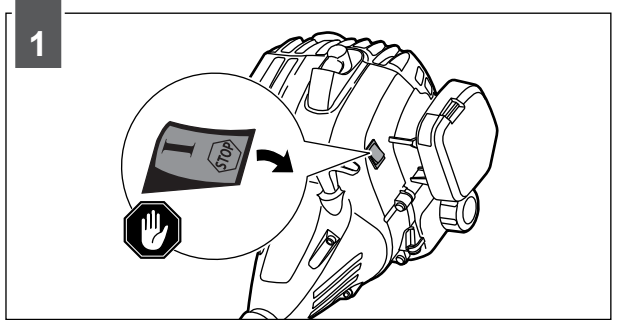

NOTE: If a cutting blade is fitted, cover it with the blade protector.

4. Store the product in a cool, dry, and well-ventilated place that is inaccessible to children. Keep away from corrosive agents such as garden chemicals and deicing salts. Do not store outdoors.

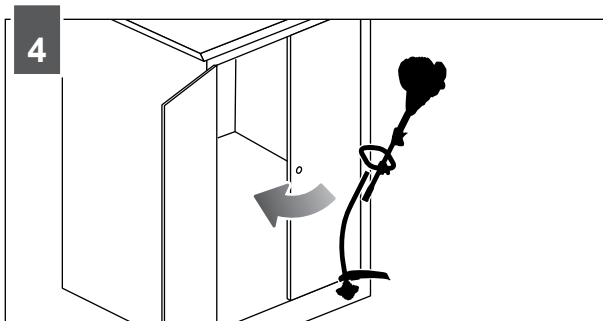

MAINTENANCE SCHEDULE

	Every 25 hours of operation	Before each use	After first month or 20 hours of operation	Every 3 months or 50 hours of operation	Every 6 months or 100 hours of operation	Every year or after 300 hours or operation
Check if fastener is fully tightened		■				
Check: Cutting attachment must not rotate in idle mode ²		■				
Clean spark arrestor	■					
Replace spark arrestor						■
Clean air filter	■					
Change air filter						■
Check or adjust spark plug					■	
Replace spark plug						■
Clean fuel tank and filter ¹				■		
Check fuel line		■				
Replace fuel filter ¹						■
Check all hose connections		■				
Inspect fuel tank vapor vent (if equipped)		■				
Clean the exhaust port and silencer	■					

¹ These items should only be carried out by an authorised service centre.

² If this requirement is not met, contact an authorised service centre for repair or adjustment.

NOTES:

- Maintenance should be performed more frequently when product is used in dusty areas.
- When product has exceeded the maximum figures specified in the table, maintenance should still be cycled according to the intervals of time or hours stated herein.

TROUBLESHOOTING

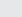
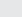
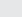
Problem	Possible cause	Solution
	No fuel.	Push primer bulb until the bulb is full of fuel. If the bulb does not fill, the primary fuel delivery system is blocked. If the primer bulb fills, the engine may be flooded. (See next item.)
	Flooded engine.	<ul style="list-style-type: none"> ■ Turn the on/off switch to the "STOP" (Off) position. ■ Completely remove the spark plug from the engine and spark plug boot, then turn the product so the spark plug hole is aimed at the ground. ■ Set the choke lever to  position and pull starter cord 10-15 times. This will clear excessive fuel from the engine. ■ Remove any expelled fuel from the product. ■ Clean and reinstall the spark plug. ■ Clean up any spilled fuel and move at least 9 m away before restarting. ■ Pull starter handle 3 times with the choke lever at  position. ■ If the engine does not start, set the choke lever to  choke position and repeat the normal starting procedure. ■ If the engine still fails to start, repeat procedure with a new spark plug.
	Starter cord is hard to pull.	Contact an authorised service dealer.
	No spark.	Remove the spark plug. Reattach the spark plug cap and lay the spark plug on the metal cylinder. Pull the starter cord and watch for a spark at the spark plug tip. If there is no spark, repeat the test with a new spark plug.
Engine does not reach full speed and emits excessive smoke.	Check oil fuel mixture.	Use fresh fuel and the correct 2-stroke oil mix.
	Air filter is dirty.	Clean the air filter according to the instructions in the Maintenance section.
	Spark arrestor screen is dirty.	Contact an authorised service dealer.
Grass wraps around the trimmer head assembly and the attachment shaft.	Cutting tall grass at ground level.	Cut tall grass from the top down.
	Operating the product at part throttle.	Operate the product at full throttle.
Oil drips from muffler.	Operating the product at part throttle.	Operate the product at full throttle.
	Oil/fuel mixture is incorrect.	Use fresh fuel and the correct 2-stroke oil mix.
	Air filter is dirty.	Clean the air filter according to the instructions in the Maintenance section.

PRODUCT SPECIFICATIONS

Grass trimmer	
Model	HBLT25CD
Weight	
- Without fuel, cutting attachment and harness	4.30 Kg
-Without fuel and harness, with cutting attachment	4.4 Kg
Fuel tank volume	250 cm ³
Cutting swath	432 mm
Diameter of cutting line	2.4 mm
Engine displacement	26 cm ³ /cc
Maximum engine performance (in accordance with ISO 8893)	0.80 kW
Rated engine performance	0.65 kW
Maximum rotational frequency of the spindle	12000 min ⁻¹
Engine speed (rotational frequency) at idle	2800-3600 min ⁻¹
Fuel consumption (in accordance with ISO 8893) at max. engine performance	0.45 kg/h
Specific fuel consumption (in accordance with ISO 8893) at max. engine performance	0.56 kg/kw.h
Vibration	
Front handle	
Idle	4.1 m/s ²
Racing	12.1 m/s ²
Equivalent vibration total value	9.0 m/s ²
Uncertainty	1.5 m/s ²
Rear handle	
Idle	3.3 m/s ²
Racing	8.7 m/s ²
Equivalent vibration total value	6.6 m/s ²
Uncertainty	1.5 m/s ²
Sound level	
Sound pressure level at the operator's position	93.8 dB(A)
Bystander sound pressure level	76.3 dB(A)

REPLACEMENT PARTS

Parts	Accessory number	Part number
String head		308895001
Spare string line		528721006
Grass deflector		308744009
Spool retainer		308043002

Homelite®

Imported by:

Techtronic Industries Australia Pty. Ltd.
31 Gilby Road, Mount Waverly, VIC 3149,
Melbourne, Australia

Techtronic Industries NZ Limited
2 Landing Drive, Mangere,
Auckland, 2022 , New Zealand

xxxxxxxxxxxxxxxxxxxx