

ozito

MINI AIR COMPRESSOR WITH AIRBRUSH KIT

150W

INSTRUCTION MANUAL

SPECIFICATIONS

Voltage:	220-240V ~50Hz
Power:	150W
No Load Speed:	1,450/min
Max. Pressure:	57psi (4bar)
Auto Cut-in Pressure:	43psi (3bar)
Flow Rate:	15L/min
Air Outlet Size:	1/8" BSP
Airbrush Operating Pressure:	15-50psi (1-3.5bar)
Weight:	3.98kg

ozito.com.au

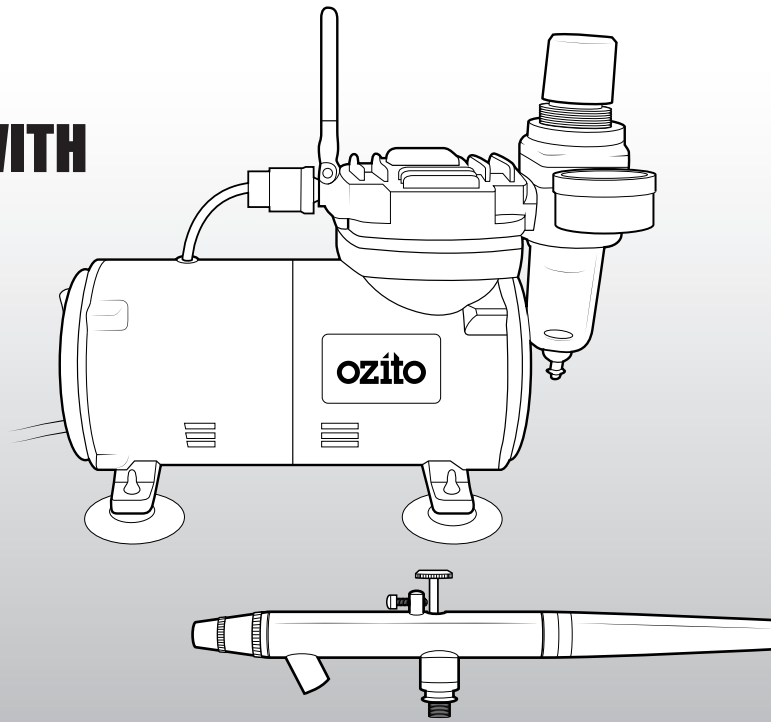

WHAT'S IN THE BOX

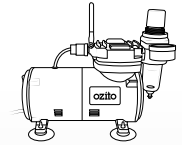

Mini Air Compressor

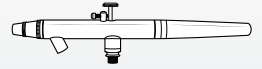

Airbrush



5ml Paint Cup



2 x Paint Pots



Air Hose



Spanner & Hanging Hook

3 YEAR REPLACEMENT WARRANTY

MAC-2000

WARRANTY

IN ORDER TO MAKE A CLAIM UNDER THIS WARRANTY YOU MUST RETURN THE PRODUCT TO YOUR NEAREST BUNNINGS WAREHOUSE WITH YOUR BUNNINGS REGISTER RECEIPT. PRIOR TO RETURNING YOUR PRODUCT FOR WARRANTY PLEASE TELEPHONE OUR CUSTOMER SERVICE HELPLINE:

Australia 1800 069 486

New Zealand 0508 069 486

TO ENSURE A SPEEDY RESPONSE PLEASE HAVE THE MODEL NUMBER AND DATE OF PURCHASE AVAILABLE. A CUSTOMER SERVICE REPRESENTATIVE WILL TAKE YOUR CALL AND ANSWER ANY QUESTIONS YOU MAY HAVE RELATING TO THE WARRANTY POLICY OR PROCEDURE.

The benefits provided under this warranty are in addition to other rights and remedies which are available to you at law. Our goods come with guarantees that cannot be excluded at law. You are entitled to a replacement or refund for a major failure and for compensation for any other reasonably foreseeable loss or damage. You are also entitled to have the goods repaired or replaced if the goods fail to be of acceptable quality and the failure does not amount to a major failure.

Generally you will be responsible for all costs associated with a claim under this warranty, however, where you have suffered any additional direct loss as a result of a defective product you may be able to claim such expenses by contacting our customer service helpline above.

3 YEAR REPLACEMENT WARRANTY

Your product is guaranteed for a period of **36 months from the original date of purchase**. If a product is defective it will be replaced in accordance with the terms of this warranty. Warranty excludes consumable parts.

WARNING

The following actions will result in the warranty being void.

- If the tool has been operated on a supply voltage other than that specified on the tool.
- If the tool shows signs of damage or defects caused by or resulting from abuse, accidents or alterations.
- Failure to perform maintenance as set out within the instruction manual.
- If the tool is disassembled or tampered with in any way.
- Professional, industrial or high frequency use.

KNOW YOUR PRODUCT

MINI AIR COMPRESSOR

- | | |
|---------------------------|------------------|
| 1 On/Off Switch | 5 Drain Valve |
| 2 Rubber Feet | 6 Pressure Gauge |
| 3 Carry Handle | 7 Air Outlet |
| 4 Pressure Regulator Knob | |

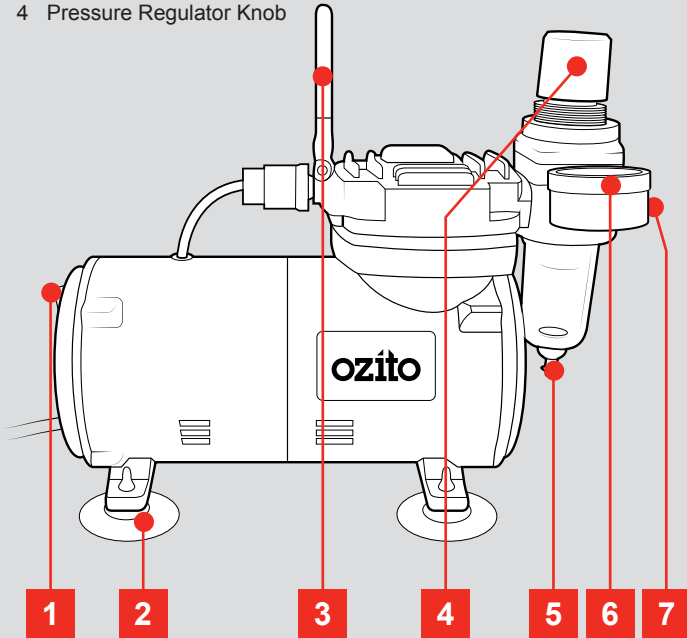

AIRBRUSH

- | | |
|----------------------|--------------------------|
| 8 Push On Nozzle Cap | 11 Paint Regulator Screw |
| 9 Paint Outlet | 12 Air Inlet |
| 10 Paint Inlet | 13 Variable Trigger |

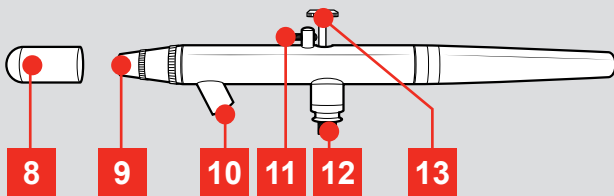

ACCESSORIES

- | | |
|--------------------|-----------------|
| 14 Paint Cup (5ml) | 17 Hanging Clip |
| 15 Paint Pot x 2 | 18 Air Hose |
| 16 Wrench | |

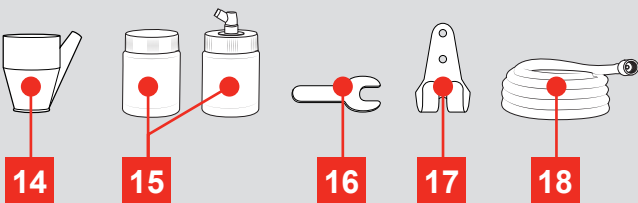

ONLINE MANUAL

Scan this QR Code with your mobile device to take you to the online manual.



SETUP & PREPARATION

1. ASSEMBLY



WARNING: ENSURE THE TOOL IS SWITCHED OFF AND DISCONNECTED FROM THE POWER SUPPLY BEFORE PERFORMING ANY OF THE FOLLOWING STEPS.

Connecting the Airbrush to the Compressor

- 1 Wrap the threaded male air inlet of the airbrush and the air outlet of the air compressor with thread seal tape in a clockwise direction.

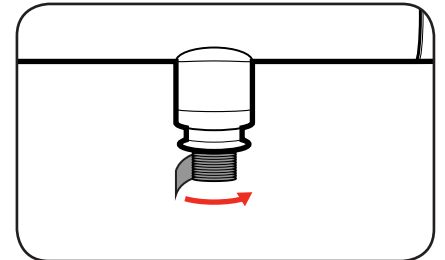

- 2 Attach one end of the air hose to the air compressor outlet by rotating clockwise.

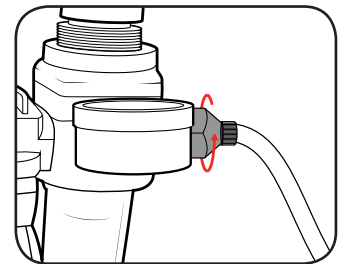

- 3 Attach the other end of the air hose to the air inlet of the airbrush.

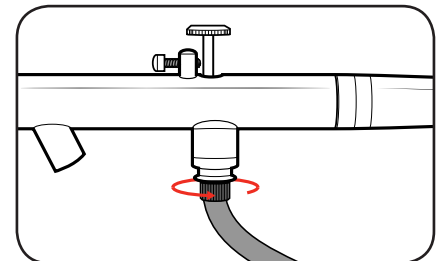

Installing the Paint Pot

- 1 Ensure the lid with the connection hood is fitted securely to the paint pot.

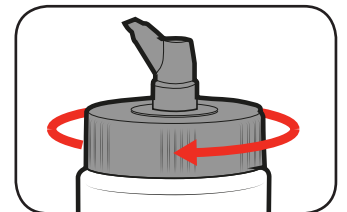

- 2 Push the lid of the paint pot into the paint inlet of the airbrush firmly.

Note: You can also insert the 5ml paint pot for small tasks.

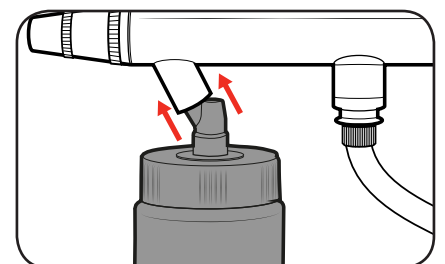

3 YEAR REPLACEMENT WARRANTY

2. AIRBRUSH CONTROLS

Variable Trigger

- 1 Press and hold the variable trigger down to allow air to flow through the airbrush.

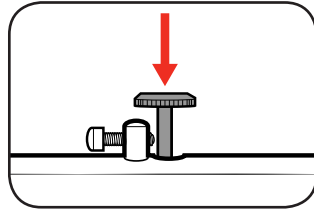

- 2 Pull the variable trigger backwards to allow paint to be sprayed.

Note: The further the variable trigger is pulled back, the more fluid will flow through the airbrush.

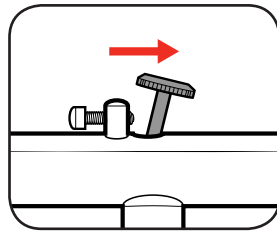

- 3 Release the variable trigger to stop spraying.

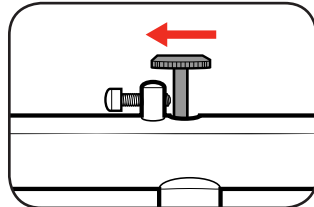

Paint Regulator Screw

The paint regulator screw is a stop that holds the variable trigger backwards, causing more fluid to be drawn from the paint pot without having to pull the trigger back manually.

- 1 For full control of the amount of paint being sprayed, completely loosen the paint regulator screw.

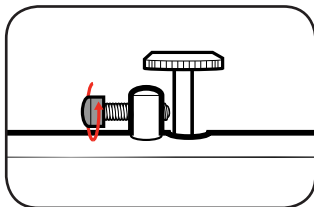

- 2 To force paint to be drawn from the paint pot as soon and the variable trigger is pressed down, tighten the paint regulator screw.

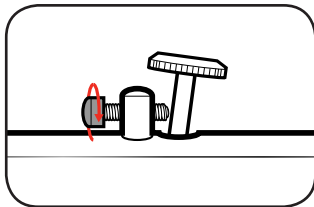

Paint Pot Vent Hole

The paint pot has a vent hole to allow air to escape which enables fluid to flow into the airbrush. Ensure it is clean and not blocked.



3. PREPARATION

NOTE: FOR BEST RESULTS, SURFACE PREPARATION AND PAINT THINNING ARE THE TWO MOST IMPORTANT AREAS. ENSURE ALL SURFACES ARE FREE OF DUST, DIRT AND GREASE.

Mixing and Thinning

The airbrush kit comes with a spare paint pot and lid that can be used for mixing the paint and reducer to obtain the desired colour or viscosity.

Note: Water based paints can be thinned using water.

Follow the manufacturers guide for thinning and mixing ratios which should be labelled on the paint container.

- 1 Before mixing any paint or thinners, work out how much of each substance is needed.

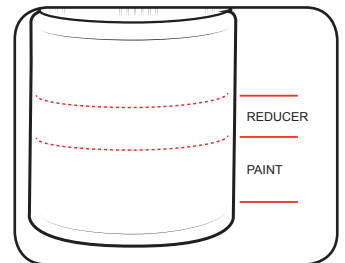

- 2 Insert the required amount of paint into the paint pot.

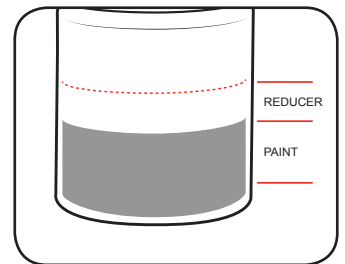

- 3 Insert the required amount of reducer into the paint pot.

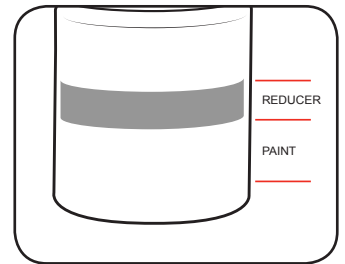

- 4 Thoroughly mix the paint and reducer in the paint pot and then attach the lid securely.

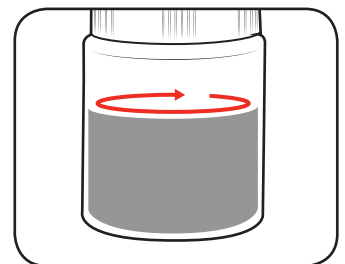

IMPORTANT! THE AIRBRUSH CANNOT BE USED WITH MATERIALS CONTAINING ABRASIVE SUBSTANCES, GLAZES, CAUSTIC OR ALKALINE SUBSTANCES.

OPERATION

4. SWITCH ON AND OFF



CAUTION! THE POWER SUPPLY FOR THIS PRODUCT SHOULD BE PROTECTED BY A RESIDUAL CURRENT DEVICE (RATED AT 30mA OR LESS).

- 1 To start operating the air compressor, push the on/off switch down into the on position.

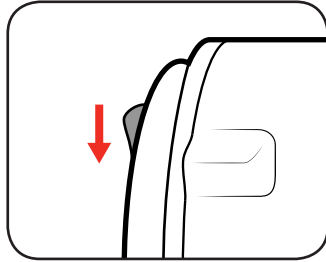

- 2 To stop operating the air compressor, push the on/off switch up into the off position.

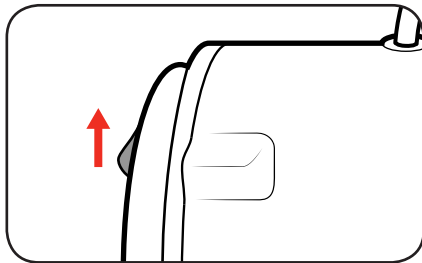

WARNING: COMPRESSED AIR CAN BE DANGEROUS. NEVER POINT THE OUTLET NOZZLE TOWARDS ANY PART OF YOUR BODY OR AT ANOTHER PERSON.

Drain Valve

The air compressor has a drain valve to ensure there is no condensation in the vessel. The compressor should be drained regularly to prevent build-up.

- 1 Press the drain valve to remove the water.

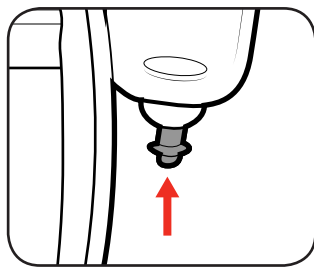

Push On Nozzle Cap

- 1 To protect the nozzle when not in use, simply push the nozzle cap over the paint outlet nozzle.

Note: Avoid rotating the nozzle cap when removing, as this may unscrew the nozzle.

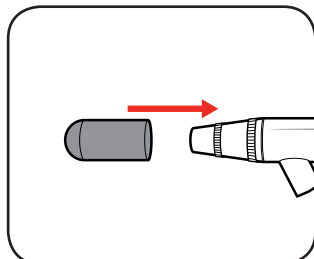

5. ADJUSTING THE PRESSURE

The airbrush has an operating pressure between 15-50psi (1-3.5bar) therefore the air compressor pressure should be adjusted before operating the airbrush.

The correct air pressure between this operating range will produce an even spray pattern with little to no splatter.

- 1 Once the air compressor is switched on, the pressure gauge will show the regulated air.

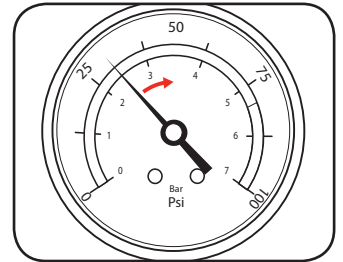

- 2 Lift the air regulator knob up to unlock the dial.

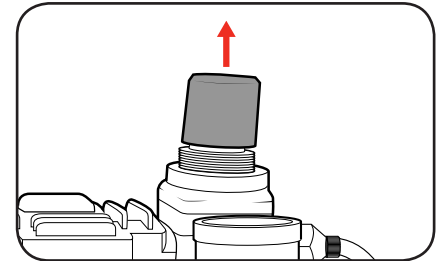

- 3 Spray onto a scrap piece of material and rotate the pressure regulator knob to adjust the operating air pressure to the desired setting.

Note: Clockwise will increase the pressure and anti-clockwise will decrease the pressure.

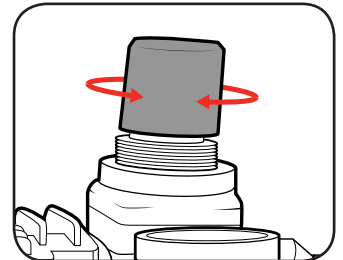

- 4 Some testing on a scrap piece of material may be required to fine tune the air pressure to achieve an even spray pattern with little to no splatter.

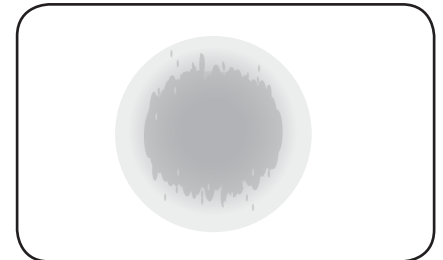

- 5 Once the desired pressure is set, press the air regulator knob down to lock the position.

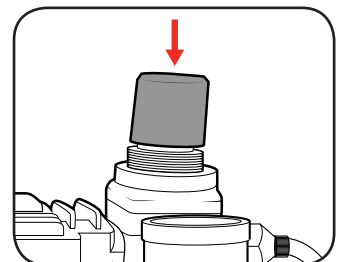

6. USING THE AIRBRUSH

Operating the Airbrush

- 1 Ensure the paint pot and air hose is fitted securely.

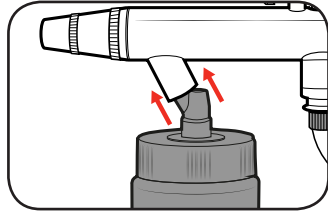

- 2 Switch the air compressor on and adjust the air pressure to the desired setting.

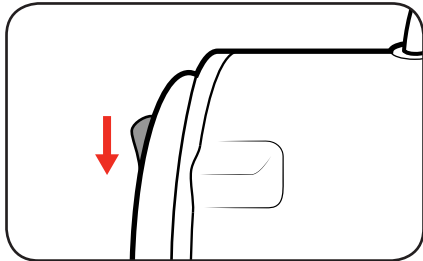

- 3 Press the variable trigger down and backwards to start spraying.

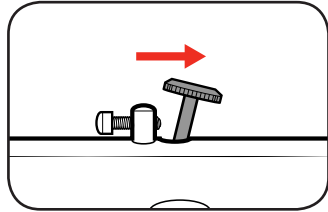

Airbrushing Technique

Airbrushing has a range of techniques to obtain different effects. Below are some basic effects that can be obtained through the motion of the airbrush and distance from the work piece.

Distance from the Work piece:

Positioning the airbrush close to the work piece, will produce a small dense pattern.

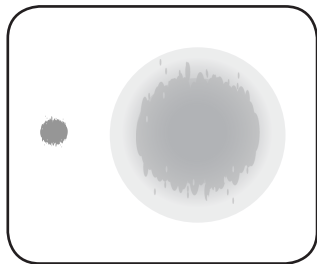

Positioning the airbrush far from the work piece, will produce a wide faint pattern.

Angle to the Work piece:

Angling the airbrush to the work piece will produce an elongated pattern that will grow wider.

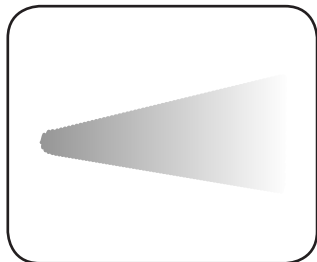

IT IS CRUCIAL TO CLEAN THE AIRBRUSH AFTER EACH USE. Please refer to the cleaning procedure.

7. CLEANING PROCEDURE

WARNING: AFTER EACH USE IT IS ESSENTIAL THAT THE AIRBRUSH IS CLEANED THOROUGHLY. FAILURE TO DO SO WILL LIKELY CAUSE BLOCKAGES WHICH WILL PREVENT THE TOOL FROM WORKING. FAILURE TO CLEAN THE TOOL WILL VOID THE WARRANTY

- 1 Empty the paint pot of remaining material.

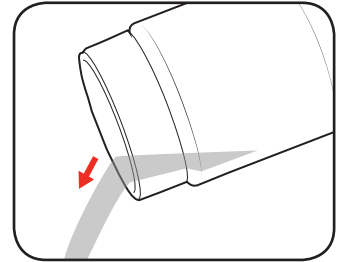

- 2 Fill paint pot with appropriate cleaning solution.

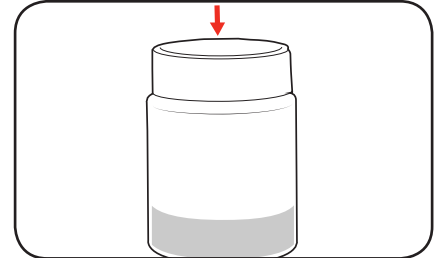

- 3 Switch the air compressor on and then spray solution onto scrap piece of material.

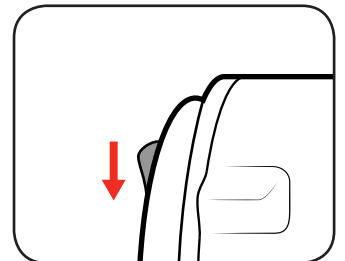

- 4 Repeat steps 2-3 until the cleaning solution runs clear from the airbrush.

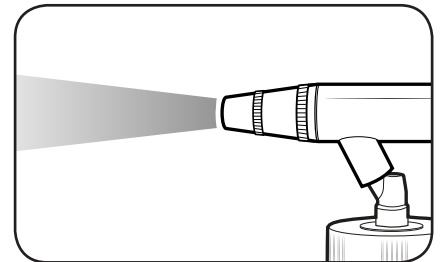

- 5 Switch the air compressor off. Remove the paint pot and rinse.

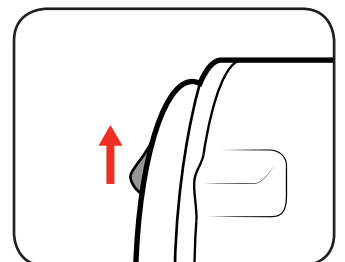

MAINTENANCE



WARNING: BEFORE CLEANING OR CARRYING OUT ANY MAINTENANCE PROCEDURE, ENSURE THE UNIT IS SWITCHED OFF, DISCONNECTED FROM THE POWER SUPPLY AND ALLOWED TO COOL DOWN.

Cleaning

- Keep the ventilation vents of the compressor clean at all times, if possible, prevent foreign matter from entering the vents.
- After each use, blow air through the compressor housing to ensure it is free from all dust particles which may build up. Build up of dust particles may cause the compressor to overheat and fail.
- If the enclosure of the compressor requires cleaning do not use solvents but a moist soft cloth only. Never let any liquid get inside the product; never immerse any part of the compressor into a liquid.

Note: Ozito Industries will not be responsible for any damage or injuries caused by the repair of the compressor by an unauthorised person or by mishandling of the product.

IMPORTANT: STORE THE COMPRESSOR ONLY IN A DRY LOCATION WHICH IS NOT ACCESSIBLE TO UNAUTHORISED PERSONS.

DESCRIPTION OF SYMBOLS

V	Volts	Hz	Hertz
~	Alternating current	W	Watts
/min	Revolutions or reciprocation per minute	no	No load speed
A	Amps	°C	Degrees Celsius
	Double insulated	kPa	Pressure rating (kilopascals)
bar	Pressure rating	L	Litres
	Regulator compliance mark		Read instruction manual
	Warning		

CARING FOR THE ENVIRONMENT



Power tools that are no longer usable should not be disposed of with household waste but in an environmentally friendly way. Please recycle where facilities exist. Check with your local council authority for recycling advice.



Recycling packaging reduces the need for landfill and raw materials. Reuse of recycled material decreases pollution in the environment. Please recycle packaging where facilities exist. Check with your local council authority for recycling advice.

TROUBLESHOOTING

Problem	Cause	Remedy
The compressor does not start	Power cord is not connected to the power.	Connect the power cord to a 240V power outlet
	On/off switch not in the on position.	Push the on/off switch into the on position
Compressor is overheating	The air vents may be obstructed, restricting the air flow.	Ensure the air vents are free from obstructions.
Little or no material flow	Nozzle clogged Paint pot vent hole blocked Paint too thick	Clean Clean Thin material
Spray pattern is heavy in the middle	Nozzle clogged Not enough atomizing pressure	Clean Increase the air pressure by rotating the pressure regulator clockwise.
Spray pattern is too wide and misty	Too much atomizing pressure	Decrease the air pressure by rotating the pressure regulator anti-clockwise.
Spray jet pulsates	Material in paint pot running out Nozzle clogged Material too thick	Refill Clean or replace Thin material
Pattern runs or sags	Applying to much material	Pull the variable trigger back less or increase movement speed
Too much over-spray	Gun too far from spray object Too much atomizing pressure	Reduce distance Decrease the air pressure by rotating the pressure regulator anti-clockwise.
Pattern is very light and splotchy	Moving the airbrush to fast	Pull the variable trigger back further or decrease movement speed

SPARE PARTS

Spare parts can be ordered from the Special Orders Desk at your local Bunnings Warehouse.

For further information, or any parts not listed here, visit www.ozito.com.au or contact Ozito Customer Service:

Australia 1800 069 486

New Zealand 0508 069 486

E-mail: enquires@ozito.com.au

ELECTRICAL SAFETY

 **WARNING!** When using mains-powered tools, basic safety precautions, including the following, should always be followed to reduce risk of fire, electric shock, personal injury and material damage.

Read the whole manual carefully and make sure you know how to switch the tool off in an emergency, before operating the tool.

Save these instructions and other documents supplied with this tool for future reference.

The electric motor has been designed for 230V and 240V only. Always check that the power supply corresponds to the voltage on the rating plate.

Note: The supply of 230V and 240V on Ozito tools are interchangeable for Australia and New Zealand.

The supply cord cannot be replaced. If the cord is damaged the appliance should be scrapped.

Note: Double insulation does not take the place of normal safety precautions when operating this tool. The insulation system is for added protection against injury resulting from a possible electrical insulation failure within the tool.

Using an Extension Lead

Always use an approved extension lead suitable for the power input of this tool. Before use, inspect the extension lead for signs of damage, wear and ageing. Replace the extension lead if damaged or defective.

When using an extension lead on a reel, always unwind the lead completely. Use of an extension lead not suitable for the power input of the tool or which is damaged or defective may result in a risk of fire and electric shock.

GENERAL POWER TOOL SAFETY WARNINGS-PERSONAL SAFETY

 **WARNING!** Read all safety warnings and all instructions. Failure to follow the warnings and instructions may result in electric shock, fire and/or serious injury. Save all warnings and instructions for future reference. The term "power tool" in the warnings refers to your mains-operated (corded) power tool or battery-operated (cordless) power tool.

1. Work area safety

- Keep work area clean and well lit. Cluttered or dark areas invite accidents.
- Do not operate power tools in explosive atmospheres, such as in the presence of flammable liquids, gases or dust. Power tools create sparks which may ignite the dust or fumes.
- Keep children and bystanders away while operating a power tool. Distractions can cause you to lose control.

2. Electrical safety

- Power tool plugs must match the outlet. Never modify the plug in any way. Do not use any adapter plugs with earthed (grounded) power tools. Unmodified plugs and matching outlets will reduce risk of electric shock.
- Avoid body contact with earthed or grounded surfaces, such as pipes, radiators, ranges and refrigerators. There is an increased risk of electric shock if your body is earthed or grounded.
- Do not expose power tools to rain or wet conditions. Water entering a power tool will increase the risk of electric shock.
- Do not abuse the cord. Never use the cord for carrying, pulling or unplugging the power tool. Keep cord away from heat, oil, sharp edges or moving parts. Damaged or entangled cords increase the risk of electric shock.
- When operating a power tool outdoors, use an extension cord suitable for outdoor use. Use of a cord suitable for outdoor use reduces the risk of electric shock.
- If operating a power tool in a damp location is unavoidable, use a residual current device (RCD) protected supply. Use of an RCD reduces the risk of electric shock.

3. Personal safety

- Stay alert, watch what you are doing and use common sense when operating a power tool. Do not use a power tool while you are tired or under the influence of drugs, alcohol or medication. A moment of inattention while operating power tools may result in serious personal injury.
- Use personal protective equipment. Always wear eye protection. Protective equipment such as dust mask, non-skid safety shoes, hard hat, or hearing protection used for appropriate conditions will reduce personal injuries.
- Prevent unintentional starting. Ensure the switch is in the off-position before connecting to power source and/or battery pack, picking up or carrying the tool. Carrying power tools with your finger on the switch or energising power tools that have the switch on invites accidents.

- Remove any adjusting key or wrench before turning the power tool on.

A wrench or a key left attached to a rotating part of the power tool may result in personal injury.

- Do not overreach. Keep proper footing and balance at all times. This enables better control of the power tool in unexpected situations.
 - Dress properly. Do not wear loose clothing or jewellery. Keep your hair, clothing and gloves away from moving parts. Loose clothes, jewellery or long hair can be caught in moving parts.
 - If devices are provided for the connection of dust extraction and collection facilities, ensure these are connected and properly used. Use of dust collection can reduce dust-related hazards.
- ## 4. Power tool use and care
- Do not force the power tool. Use the correct power tool for your application. The correct power tool will do the job better and safer at the rate for which it was designed.
 - Do not use the power tool if the switch does not turn it on and off. Any power tool that cannot be controlled with the switch is dangerous and must be repaired.
 - Disconnect the plug from the power source and/or the battery pack from the power tool before making any adjustments, changing accessories, or storing power tools. Such preventive safety measures reduce the risk of starting the power tool accidentally.
 - Store idle power tools out of the reach of children and do not allow persons unfamiliar with the power tool or these instructions to operate the power tool. Power tools are dangerous in the hands of untrained users.
 - Maintain power tools. Check for misalignment or binding of moving parts, breakage of parts and any other condition that may affect the power tool's operation. If damaged, have the power tool repaired before use. Many accidents are caused by poorly maintained power tools.
 - Keep cutting tools sharp and clean. Properly maintained cutting tools with sharp cutting edges are less likely to bind and are easier to control.
 - Use the power tool, accessories and tool bits etc. in accordance with these instructions, taking into account the working conditions and the work to be performed. Use of the power tool for operations different from those intended could result in a hazardous situation.

5. Service

- Have your power tool serviced by a qualified repair person using only identical replacement parts. This will ensure that the safety of the power tool is maintained.



GENERAL AIR TOOL SAFETY WARNINGS



WARNING! Read all safety warnings and all instructions. Failure to follow the warnings and instructions may result in electric shock, fire and/or serious injury.

Save all warnings and instructions for future reference. The term "power tool" in the warnings refers to your mains-operated (corded) power tool or battery-operated (cordless) power tool.

1. Work area safety

- Keep work area clean and well lit.** Cluttered or dark areas invite accidents.
- Do not operate power tools in explosive atmospheres, such as in the presence of flammable liquids, gases or dust.** Power tools create sparks which may ignite the dust or fumes.
- Keep children and bystanders away while operating a power tool.** Distractions can cause you to lose control.
- Dress properly. Do not wear loose clothing or jewellery. Keep your hair, clothing and gloves away from moving parts.** Loose clothes, jewellery or long hair can be caught in moving parts.
- Check the maximum pressure rating of any tools or accessories that you intend using with the compressor. The output pressure of the air from the compressor must be regulated so that it never exceeds the rated pressure of the tool or accessory.
- Always wear safety goggles or glasses when using the air compressor. Never point the nozzle of an accessory towards any part of your body or towards another person.
- Drain the moisture from the tank daily.** It will help prevent corrosion.
- Use safety equipment including safety goggles or shield, ear protection, breathing or respirator mask and protective clothing.
- The tool must be used only for its prescribed purpose. Any use other than those mentioned in this Manual will be considered a case of misuse. The user and not the manufacturer shall be liable for any damage or injury resulting from such cases of misuse.



WARNING! In the event that an air line is cut or broken, the air supply must be turned off at the compressor. A broken air line which is not supported is extremely dangerous and can whip around very quickly, both with the capability of striking people, and blowing foreign particles into the air.

- Do not attempt to catch the air line but immediately keep bystanders well clear and turn off the air supply to the hose, turn off the compressor at the On / Off button, and then remove the hose from the compressor.
- This appliance is not intended for use by persons (including children) with reduced physical, sensory or mental capabilities, or lack of experience and knowledge, unless they have been given the supervision or instruction concerning use of the appliance by a person responsible for their safety.
- Children should be supervised to ensure that they do not play with the appliance.



AIR COMPRESSOR & AIRBRUSH SAFETY WARNINGS

This appliance is not intended for use by persons (including children) with reduced physical, sensory or mental capabilities, or lack of experience and knowledge, unless they have been given supervision or instruction concerning use of the appliance by a person responsible for their safety.

Children should be supervised to ensure that they do not play with the appliance.

- Do not place the hose end against any part of your body when turned on, as this may infuse air into your blood stream putting your health at serious risk.
- Do not make any alterations to this air compressor. Only use the adaptors supplied with this product.
- Use this product only in accordance with operation instructions included in this manual.
- Inspect each part before use. Do not use if bent, broken, melted, burnt or if the unit appears to be damaged.
- Do not bend or pinch the air hose while the Compressor is in use.
- If the compressor is making abnormal sounds or its temperature is quite high, turn off the power straight away and let it cool for at least 10 minutes before trying again. Improper use may result in damage of the compressor.
- Do not leave unattended and operating. Keep out of reach of children.
- Put the compressor in a dry place if it is not in use for an extended period of time.
- Keep the compressor away from flammable liquid or gas. Do not allow the compressor to become wet.
- Never put the connector and adaptors into your mouth, ear or eye. They are not toys.
- Avoid inserting hands into the inlets/outlets of the compressor while it is connected to power.
- Before using the compressor, always inspect it visually. Do not use the compressor if it is cracked and/or damaged. If the compressor is damaged, contact Ozito customer service.
- Never work or perform maintenance on the compressor without first making sure it

has been disconnected from the mains power.

IMPORTANT:

- The electrical connection must always be made in a dry area. Make sure that electrical connections are protected from inundations.
- Protect the plug and the power cable from heat, oil or sharp edges.
- If damaged, The power cable must be replaced by a qualified electrician.

NEVER under any circumstances aim the nozzle at another person or animal.

- In the event of an injury occurring, seek medical advice immediately.
- The airbrush must not be used for spraying flammable paints and solvents with a flash point of less than 21°C.
- Always ensure there is adequate ventilation when spraying.
- Eye protection is recommended to keep hazardous vapours and liquids out of eyes.
- Always wear a face mask when spraying.
- Always read the paint manufacturers thinning instructions before using.
- Always keep the spray nozzle in place during use. Never allow the spray to come in direct contact with the skin.
- Never immerse the airbrush in liquid.
- The airbrush must not be cleaned by using flammable liquids with a flash point of less than 21°C.

NEVER spray near a naked flame, including an appliance pilot light.

NEVER smoke whilst spraying.

NEVER allow children to operate or play with the airbrush.

- Before cleaning, always disconnect the appliance from the air supply.
- Always disconnect from air supply when refilling the paint pot.
- After every use ensure you clean your airbrush thoroughly.

NEVER use the airbrush outside when it is raining.