

# ozito

## DUAL POWER INFLATOR

12V / 240V

### INSTRUCTION MANUAL

### SPECIFICATIONS

Voltage:	12V DC & 230-240V AC
Power:	120W - DC 180W - AC
Max Pressure:	120PSI
Flow Rate @ 30PSI:	9.9 l/min - DC 14.1 l/min - AC
S3:	25% (150s on & 450s off)
Weight:	2.35kg

[ozito.com.au](http://ozito.com.au)

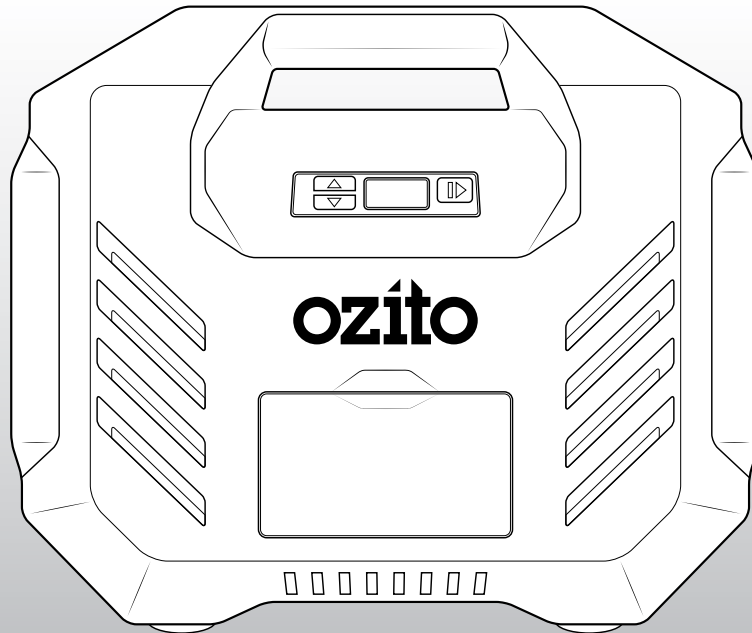

### WHAT'S IN THE BOX

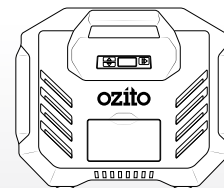

Dual Power Inflator

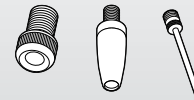

Adaptors x 3

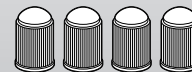

Valve Caps x 4

**3** YEAR REPLACEMENT WARRANTY

DPI-5000

# KNOW YOUR PRODUCT

## FRONT VIEW

- 1 AC Power Cord
- 2 Power Mode Switch
- 3 Target Pressure Buttons
- 4 LCD Screen
- 5 Run / Pause Button
- 6 Accessories Compartment

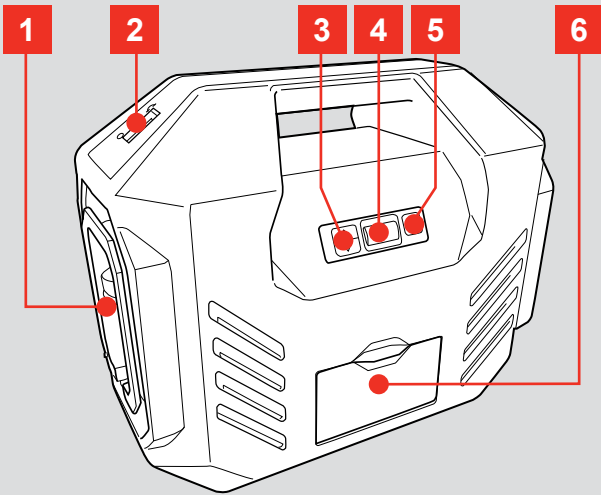

## BACK VIEW

- 7 Air Hose
- 8 Valve Caps x 4
- 9 Carry Handle
- 10 12V DC Cord Compartment

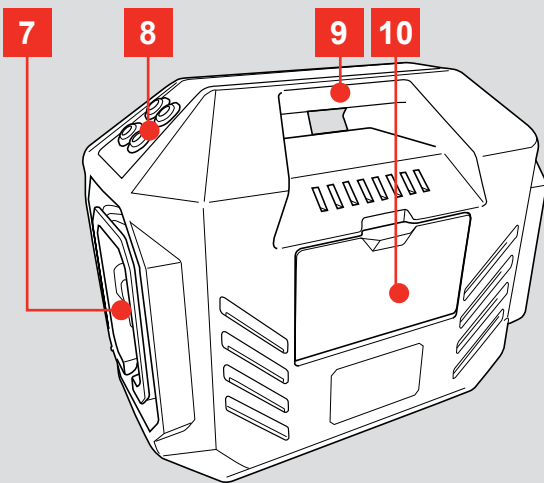

## ACCESSORIES

- 11 Presta Adaptor
- 12 General Purpose Adaptor
- 13 Ball Adaptor

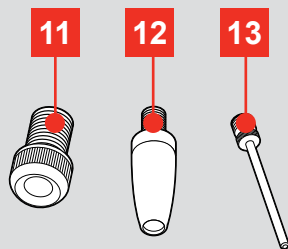

## ONLINE MANUAL

Scan this QR Code with your mobile device to take you to the online manual.



# SETUP & PREPARATION

## 1. ADAPTORS & ACCESSORIES



**WARNING:** ENSURE THE TOOL IS SWITCHED OFF AND DISCONNECTED FROM THE POWER SUPPLY BEFORE PERFORMING ANY OF THE FOLLOWING STEPS.

### Attaching Adaptors

The inflator unit has 3 adaptors to allow a range of functions. All the adaptors are secured in the compartment at the front of the unit.

- 1 Open the compartment at the front of the compressor.

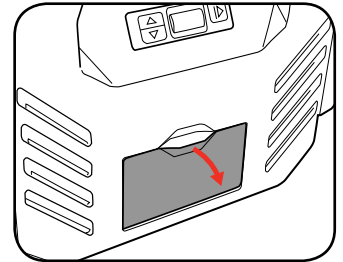

- 2 Remove the desired adaptor for the inflation task.

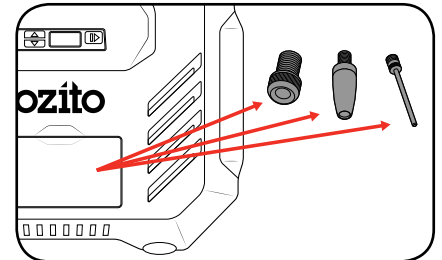

- 3 Unreel the air hose at the right side of the unit and unlock by lifting the locking lever.

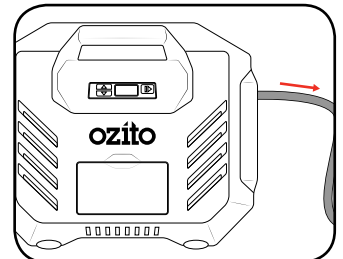

- 4 Insert the adaptor into the hose nozzle and lock by pushing down the locking lever.

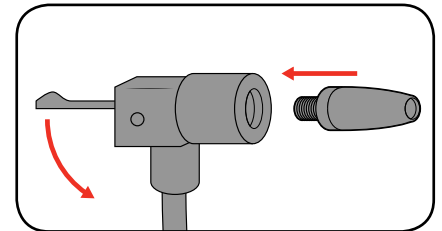

### Valve Caps

The unit is supplied with 4 valve caps incase one is lost or broken.

- 1 Remove the valve cap from the right side of the carry handle.

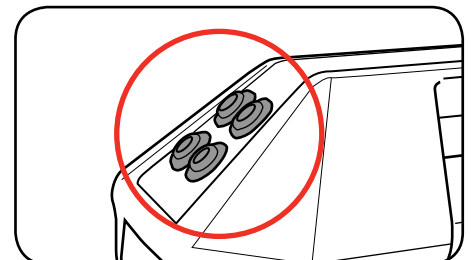

# 3 YEAR REPLACEMENT WARRANTY

# OPERATION

## 2. CONNECTING TO POWER

### Connecting to a 12V DC Outlet

- 1 Remove the 12V socket from the compartment at the back of the unit and roll out.

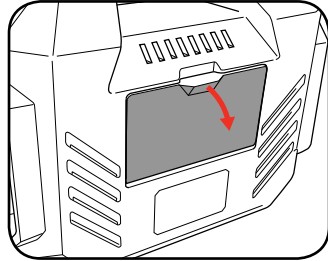

- 2 Connect the 12V socket to a 12V DC outlet which can be found in your vehicle.

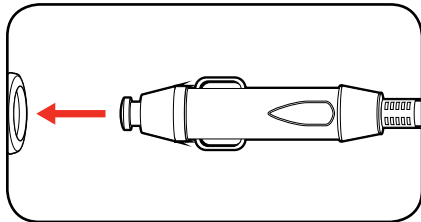

- 3 Push the power mode switch into the DC 12V setting.

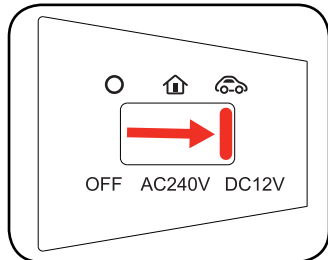

### Connecting to a 240V AC Outlet

- 1 Remove the 240V power cord from the left of the unit and roll out.

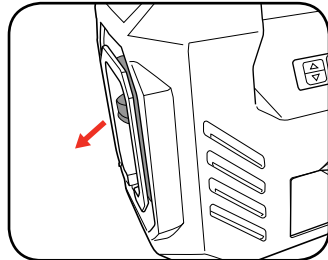

- 2 Plug the cord into a 240V AC power outlet.

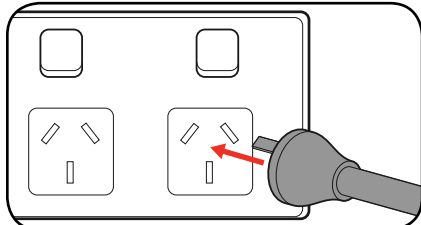

- 3 Push the power mode switch into the AC 240V setting.

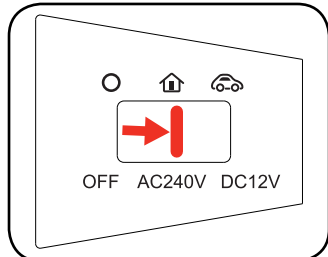

## 3. CONTROLS

### Setting the Target Pressure

The unit can inflate an item to a preset target pressure within the range of 3 - 120 PSI. Once the pressure is obtained the unit will automatically shut off.

- 1 To increase the target pressure, press the upper target pressure button.
- 2 To decrease the target pressure, press the lower target pressure button.

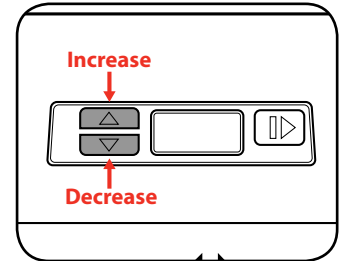

**Note:** The set target pressure will flash 3 times on the LCD screen and then return to the current pressure display.

### Run / Pause Button

The unit can be stopped prior to the preset target pressure is reached using the run / pause button and can then be resumed if desired.

- 1 To start inflating an item, press the Run/Pause button.
- 2 To stop or pause inflating an item prior to the set target pressure is reached, press the Run/Pause button.

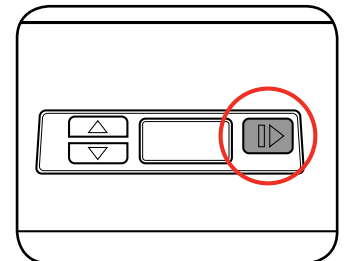

**WARNING!** COMPRESSED AIR CAN BE DANGEROUS. NEVER POINT THE OUTLET NOZZLE TOWARDS ANY PART OF YOUR BODY OR ANOTHER PERSON.

## 4. INFLATING



**IMPORTANT:** BEFORE CONNECTING OR DISCONNECTING ACCESSORIES, ALWAYS MAKE SURE THAT THE INFLATOR IS OFF.

- 1 Attach the required adaptor for the job and ensure it is secured with the hose locking lever.

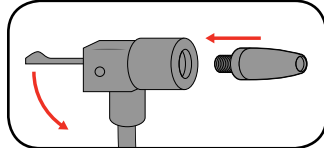

- 2 Connect the unit to the desired power supply and switch the power mode switch into the correct setting.

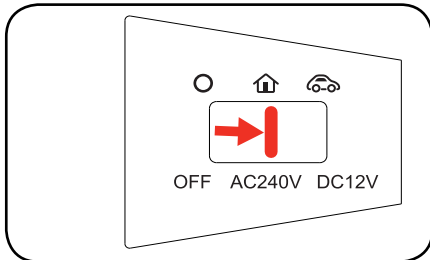

- 3 Insert / Attach the hose adaptor to the item to be inflated.

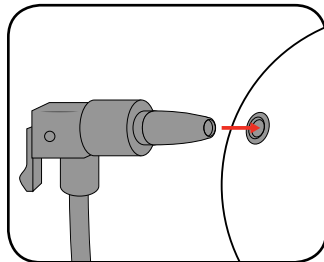

- 4 Adjust the target pressure using the target pressure buttons.

**NOTE:** The required pressure should be written on the item.

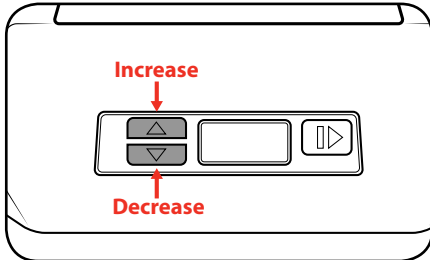

**WARNING:** AVOID INFLATING THE OBJECTS ABOVE THE RECOMMENDED INFLATION PRESSURE. THIS MAY LEAD TO DAMAGE AND/OR INJURIES.

- 5 Start inflating by pressing the Run / Pause button. The current inflation pressure will display on the LCD screen.

**NOTE:** The unit will automatically shut off once the target pressure has been reached.

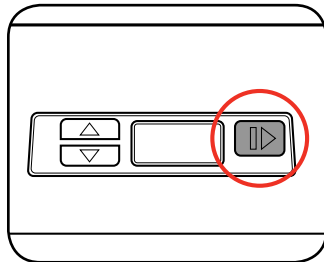

## 5. REPLACING 12V DC FUSE



**WARNING:** ENSURE THE TOOL IS SWITCHED OFF AND DISCONNECTED FROM THE POWER SUPPLY BEFORE PERFORMING ANY OF THE FOLLOWING STEPS.

The 12V socket is fitted with a 10A fuse to protect the inflator. If the unit has stopped working and the LCD display does not illuminate, the fuse may need to be replaced.

- 1 Unscrew the top of the 12V socket to expose the fuse.

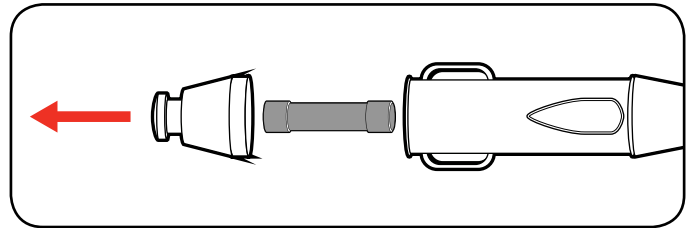

- 2 Replace the 10A fuse and screw the top back onto the 12V socket.

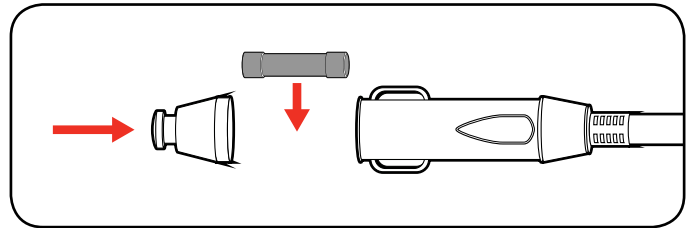

# TROUBLESHOOTING

Problem	Cause	Solution
The inflator does not start	Inflator not connected to the power	Connect the unit to a 12V DC or 230-240V AC outlet
	Incorrect power mode selected	Ensure correct power mode is selected with the power mode switch
	Insufficient supply voltage	Try another power outlet
	12V Fuse needs replacing	Replace Fuse
The inflator starts but there is no pressure	Loose hose connections	Check the compressed air hose and adaptor and replace if necessary
	The seals are damaged	Check the seals and have any damaged seals replaced by a service centre
LCD display wont turn on	Compressor not connected to the power	Connect the unit to a 12V DC or 230-240V AC outlet
The unit automatically stops before the item is fully inflated	Target pressure setting is set too low	Adjust the target pressure to the required value indicated on the inflatable item

# CARING FOR THE ENVIRONMENT



Power tools that are no longer usable should not be disposed of with household waste but in an environmentally friendly way. Please recycle where facilities exist. Check with your local council authority for recycling advice.



Recycling packaging reduces the need for landfill and raw materials. Reuse of recycled material decreases pollution in the environment. Please recycle packaging where facilities exist. Check with your local council authority for recycling advice.

# SPARE PARTS

Spare parts can be ordered from the Special Orders Desk at your local Bunnings Warehouse.

For further information, or any parts not listed here, visit [www.ozito.com.au](http://www.ozito.com.au) or contact Ozito Customer Service:

Australia 1800 069 486

New Zealand 0508 069 486

E-mail: [enquires@ozito.com.au](mailto:enquires@ozito.com.au)

# DESCRIPTION OF SYMBOLS

<b>V</b>	Volts	<b>Hz</b>	Hertz
<b>mA</b>	Milliamperes	<b>W</b>	Watts
<b>ac / ~</b>	Alternating current	<b>dc</b>	Direct current
<b>/min</b>	Revolutions or reciprocation per minute	<b>S3</b>	Intermittent periodic duty
<b>A</b>	Amps	<b>°C</b>	Degrees Celsius
<b>PSI</b>	Pressure rating	<b>kPa</b>	Pressure rating (kilopascals)
<b>bar</b>	Pressure rating	<b>L</b>	Litres
	Regulator compliance mark		Double insulated
	Read instruction manual	<b>l/min</b>	Litres per minute
	Warning		

# MAINTENANCE



**WARNING:** BEFORE CLEANING YOUR INFLATOR OR CARRYING OUT ANY MAINTENANCE PROCEDURE, ENSURE THE UNIT IS SWITCHED OFF AND DISCONNECTED FROM THE POWER SUPPLY.



**WARNING:** WAIT UNTIL THE INFLATOR HAS COMPLETELY COOLED DOWN TO PREVENT BURNS.

## Cleaning

- Keep the ventilation vents of the inflator clean at all times, if possible, prevent foreign matter from entering the vents.
- After each use, blow air through the inflator housing to ensure it is free from all dust particles which may build up. Build up of dust particles may cause the inflator to overheat and fail.
- If the enclosure of the inflator requires cleaning do not use solvents but a moist soft cloth only. Never let any liquid get inside the inflator; never immerse any part of the inflator into a liquid.

**Note:** Ozito Industries will not be responsible for any damage or injuries caused by the repair of the inflator by an unauthorised person or by mishandling of the inflator.

**IMPORTANT:** STORE THE INFLATOR ONLY IN A DRY LOCATION WHICH IS NOT ACCESSIBLE TO UNAUTHORISED PERSONS. ALWAYS STORE UPRIGHT, NEVER TILTED!

# SPARE PARTS

Tool: 12V / 240V Dual Power Inflator  
Model No. DPI-5000

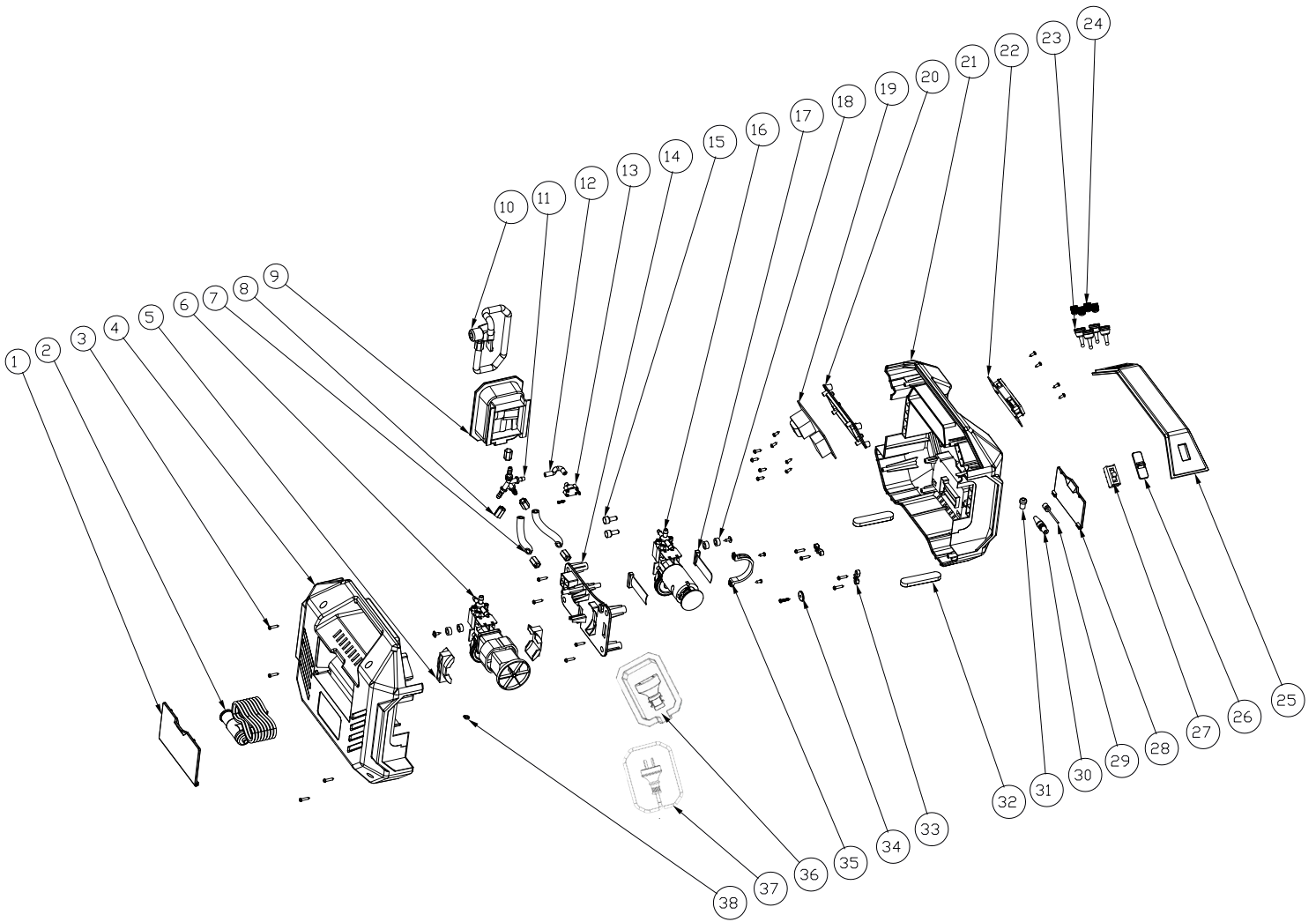

## How To Order

Available spare parts can be ordered through the Special Orders Desk at any Bunnings Warehouse. If you have any further questions, please contact Ozito Customer Service on:

Australia: 1800 069 486

New Zealand: 0508 069 486

[enquiries@ozito.com.au](mailto:enquiries@ozito.com.au)

# ELECTRICAL SAFETY

 **WARNING!** When using mains-powered tools, basic safety precautions, including the following, should always be followed to reduce risk of fire, electric shock, personal injury and material damage.

Read the whole manual carefully and make sure you know how to switch the tool off in an emergency, before operating the tool.

Save these instructions and other documents supplied with this tool for future reference.

The electric motor has been designed for DC (12V) motor and AC (230-240V) motor only. Always check that the power supply corresponds to the voltage on the rating plate.

Note: The supply of DC (12V) and AC (230-240V) on Ozito tools are interchangeable for Australia and New Zealand.



This tool is double insulated; therefore no earth wire is required.

The supply cord cannot be replaced. If the cord is damaged the appliance should be scrapped.

**Note:** Double insulation does not take the place of normal safety precautions when operating this tool. The insulation system is for added protection against injury resulting from a possible electrical insulation failure within the tool.

## Using an Extension Lead

Always use an approved extension lead suitable for the power input of this tool. Before use, inspect the extension lead for signs of damage, wear and ageing. Replace the extension lead if damaged or defective. When using an extension lead on a reel, always unwind the lead completely. Use of an extension lead not suitable for the power input of the tool or which is damaged or defective may result in a risk of fire and electric shock.

# GENERAL POWER TOOL SAFETY WARNINGS-PERSONAL SAFETY

 **WARNING!** Read all safety warnings and all instructions. Failure to follow the warnings and instructions may result in electric shock, fire and/or serious injury. Save all warnings and instructions for future reference. The term "power tool" in the warnings refers to your mains-operated (corded) power tool or battery-operated (cordless) power tool.

## 1. Work area safety

- Keep work area clean and well lit.** Cluttered or dark areas invite accidents.
- Do not operate power tools in explosive atmospheres, such as in the presence of flammable liquids, gases or dust.** Power tools create sparks which may ignite the dust or fumes.
- Keep children and bystanders away while operating a power tool.** Distractions can cause you to lose control.

## 2. Electrical safety

- Power tool plugs must match the outlet. Never modify the plug in any way. Do not use any adapter plugs with earthed (grounded) power tools.** Unmodified plugs and matching outlets will reduce risk of electric shock.
- Avoid body contact with earthed or grounded surfaces, such as pipes, radiators, ranges and refrigerators.** There is an increased risk of electric shock if your body is earthed or grounded.
- Do not expose power tools to rain or wet conditions.** Water entering a power tool will increase the risk of electric shock.
- Do not abuse the cord. Never use the cord for carrying, pulling or unplugging the power tool. Keep cord away from heat, oil, sharp edges or moving parts.** Damaged or entangled cords increase the risk of electric shock.
- When operating a power tool outdoors, use an extension cord suitable for outdoor use.** Use of a cord suitable for outdoor use reduces the risk of electric shock.
- If operating a power tool in a damp location is unavoidable, use a residual current device (RCD) protected supply.** Use of an RCD reduces the risk of electric shock.

## 3. Personal safety

- Stay alert, watch what you are doing and use common sense when operating a power tool. Do not use a power tool while you are tired or under the influence of drugs, alcohol or medication.** A moment of inattention while operating power tools may result in serious personal injury.
- Use personal protective equipment. Always wear eye protection.** Protective equipment such as dust mask, non-skid safety shoes, hard hat, or hearing protection used for appropriate conditions will reduce personal injuries.
- Prevent unintentional starting. Ensure the switch is in the off-position before connecting to power source and/or battery pack, picking up or carrying the tool.** Carrying power tools with your finger on the switch or energising power tools that have the switch on invites accidents.

- Remove any adjusting key or wrench before turning the power tool on.**

A wrench or a key left attached to a rotating part of the power tool may result in personal injury.

- Do not overreach. Keep proper footing and balance at all times.** This enables better control of the power tool in unexpected situations.
- Dress properly. Do not wear loose clothing or jewellery. Keep your hair, clothing and gloves away from moving parts.** Loose clothes, jewellery or long hair can be caught in moving parts.
- If devices are provided for the connection of dust extraction and collection facilities, ensure these are connected and properly used.** Use of dust collection can reduce dust-related hazards.

## 4. Power tool use and care

- Do not force the power tool. Use the correct power tool for your application.** The correct power tool will do the job better and safer at the rate for which it was designed.
- Do not use the power tool if the switch does not turn it on and off.** Any power tool that cannot be controlled with the switch is dangerous and must be repaired.
- Disconnect the plug from the power source and/or the battery pack from the power tool before making any adjustments, changing accessories, or storing power tools.** Such preventive safety measures reduce the risk of starting the power tool accidentally.
- Store idle power tools out of the reach of children and do not allow persons unfamiliar with the power tool or these instructions to operate the power tool.** Power tools are dangerous in the hands of untrained users.
- Maintain power tools. Check for misalignment or binding of moving parts, breakage of parts and any other condition that may affect the power tool's operation. If damaged, have the power tool repaired before use.** Many accidents are caused by poorly maintained power tools.
- Keep cutting tools sharp and clean.** Properly maintained cutting tools with sharp cutting edges are less likely to bind and are easier to control.
- Use the power tool, accessories and tool bits etc. in accordance with these instructions, taking into account the working conditions and the work to be performed.** Use of the power tool for operations different from those intended could result in a hazardous situation.

## 5. Service

- Have your power tool serviced by a qualified repair person using only identical replacement parts.** This will ensure that the safety of the power tool is maintained.

# AIR INFLATOR SAFETY WARNINGS

**This appliance is not intended for use by young or infirm persons unless supervised by a responsible person to ensure that they can use the appliance safely. Young children should be supervised to ensure that they do not play with play with the appliance.**

- When using the compressor, ensure you are parked in a safe, well lit location, off the road and with the hand brake engaged.
- Ensure your personal safety is not at risk and never use the air inflator while the car is in motion.
- Do not place the hose end against any part of your body when turned on, as this may infuse air into your blood stream putting your health at serious risk.
- Do not make any alterations to this Compressor. Only use the adaptors supplied with this product.
- Use this product only in accordance with operation instructions included in this manual.
- If the vehicle fuse is blown, only replace with identical rated fuse.
- Inspect each part before use. Do not use if bent, broken, melted, burnt or if the unit appears to be damaged.
- Check the tyre pressure before inflating. Never exceed the suggested pressure of the item being inflated. If suggested pressure is exceeded, the item being inflated may burst.
- Do not bend or pinch the air hose while the Compressor is in use.
- It is not suggested that the Compressor work continuously for more than 10 minutes. If 10 minutes of use has been reached, turn it off and let it cool for 8 minutes before using again.

- If the Compressor is making abnormal sounds or its temperature is quite high, turn off the power straight away and let it cool for at least 10 minutes before trying again. Improper use may result in damage of the Compressor.
- Do not leave unattended and operating. Keep out of reach of children.
- Put the Compressor in a dry place if it is not in use for an extended period of time.
- Keep the Compressor away from flammable liquid or gas. Do not allow the Compressor to become wet.
- Never put the connector and adaptors into your mouth, ear or eye. They are not toys.

# WARRANTY

IN ORDER TO MAKE A CLAIM UNDER THIS WARRANTY YOU MUST RETURN THE PRODUCT TO YOUR NEAREST BUNNINGS WAREHOUSE WITH YOUR BUNNINGS REGISTER RECEIPT. PRIOR TO RETURNING YOUR PRODUCT FOR WARRANTY PLEASE TELEPHONE OUR CUSTOMER SERVICE HELPLINE:

**Australia 1800 069 486**

**New Zealand 0508 069 486**

TO ENSURE A SPEEDY RESPONSE PLEASE HAVE THE MODEL NUMBER AND DATE OF PURCHASE AVAILABLE. A CUSTOMER SERVICE REPRESENTATIVE WILL TAKE YOUR CALL AND ANSWER ANY QUESTIONS YOU MAY HAVE RELATING TO THE WARRANTY POLICY OR PROCEDURE.

The benefits provided under this warranty are in addition to other rights and remedies which are available to you at law.

Our goods come with guarantees that cannot be excluded at law. You are entitled to a replacement or refund for a major failure and for compensation for any other reasonably foreseeable loss or damage. You are also entitled to have the goods repaired or replaced if the goods fail to be of acceptable quality and the failure does not amount to a major failure.

Generally you will be responsible for all costs associated with a claim under this warranty, however, where you have suffered any additional direct loss as a result of a defective product you may be able to claim such expenses by contacting our customer service helpline above.

## 3 YEAR REPLACEMENT WARRANTY

Your product is guaranteed for a period of **36 months from the original date of purchase**. If a product is defective it will be replaced in accordance with the terms of this warranty. Warranty excludes consumable parts, for example: valve adaptors and accessories.

## WARNING

**The following actions will result in the warranty being void.**

- If the tool has been operated on a supply voltage other than that specified on the tool.
- If the tool shows signs of damage or defects caused by or resulting from abuse, accidents or alterations.
- Failure to perform maintenance as set out within the instruction manual.
- If the tool is disassembled or tampered with in any way.
- Professional, industrial or high frequency use.